

# Easy Weigh

S E R I E S

## VM/VMC-500, VM/VMC-500 HAWSER, VR/VRC-1000/1200

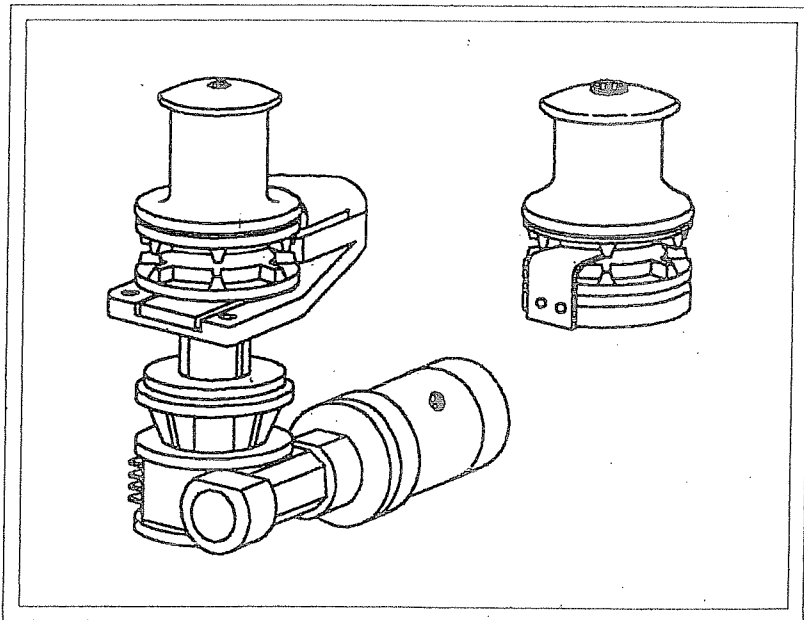

### INSTALLATION INSTRUCTIONS MANUAL

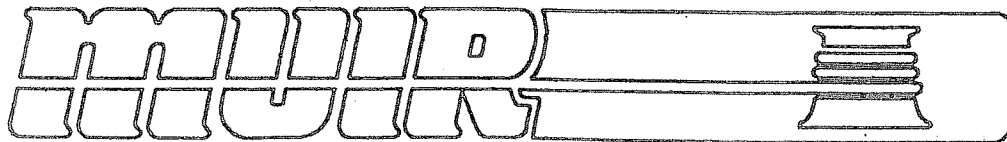

# Easy Weigh

S E R I E S

## I N S T A L L A T I O N

Above deck installation of VR/VRC 1000, VM/VMC 500 (Hawser), VR/VRC 1200

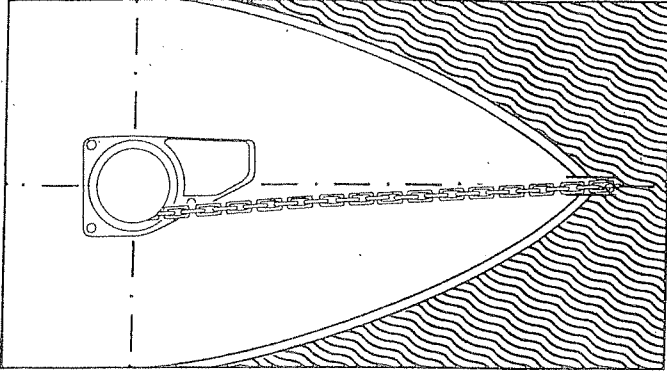

Figure (i) Locate the windlass centrally fore and aft. Check that the chain leads unhindered to the bow roller. The chain leads onto the starboard side of the gypsy, wraps around 180° and drops below deck through the chain pipe (hawser). Allow sufficient room around the windlass to allow full rotation of the windlass handle.

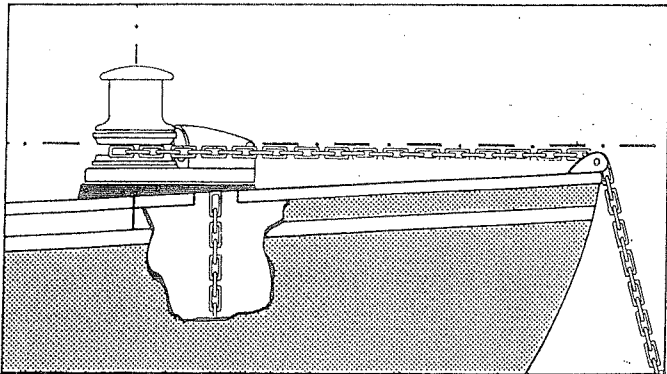

Figure (ii) The centre of the gypsy must be in the same plane as the chain lead from the bow roller. If the deck is angled (fore and aft) or curved (port to starboard) a suitably shaped mounting block will be required.

Figure (iii) Remove the gypsy from the windlass and place the shaped mounting block (if required) and deck plate in position. Mark the centres and drill four holes for the deck bolts (8 mm or 5/16ths).

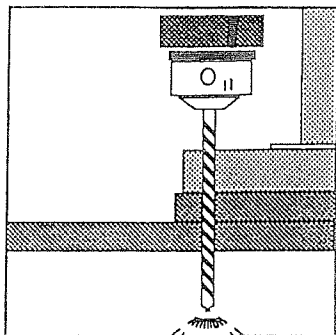
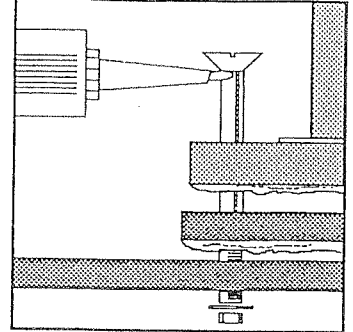

Figure (iv) apply silicone or mastic sealer under the deck plate teak mounting block and heads of the bolts. Carefully tighten the bolts and remove excess sealant.



Where the deck construction is light or of foam sandwich construction, a plywood stiffener of at least 16 mm (5/8") should be fitted to the underside of the deck to spread the load and to prevent the bolts from pulling through the deck. Large diameter washers on the underside of the ply would also help spread the load.

On assembly, grease all moving parts and the deck plate nipple with a teflon base grease.

## HANDY HINTS

It is a common mistake to locate the windlass too far forward, or too close to the bulk head, where there is insufficient room for the chain and anchor stowing.

The chain fall position should be in the centre of the chain locker, the bottom of which should be at least 750 mm (30") below the deck or 450 mm (18") of clearance above the chain end when all stowed.

If the chain falls alongside a bulkhead or onto the stem it will pyramid and jam.

If the chain fall is into an undesirable position, a metal tube can be fitted under the hawser to re-direct the chain to a preferred position. This pipe should have a maximum length of 450 mm (18") and be at least one and a half times the diameter of the chain. It should also have as much vertical angle as possible.

The separate chain pipe on the VMC500 and VM500 should be located as close to the windlass as practicable to minimise drag and ensure positive fall of chain and rope.

# Easy Weigh

S E R I E S

## OPERATION

**Manual** (all models): When releasing chain, place the handle into the central bi-square and release the clutch *anti-clockwise*. Let the anchor go and control the chain run by rotating the handle *clockwise*.

**Anchoring:** When laying on rope, a turn should be taken around a cleat or bollard. In bad weather, use a nylon bridle on the anchor chain to prevent snatching and direct load onto the windlass main shaft.

*Never use the windlass as a mooring bollard!*

**Retrieving Chain:** Place the handle in the bi-square and rotate *clockwise* to tighten the clutch. If the anchor is buried hard, motor forward to pull it free after hardening up on the windlass, to ease the load on the windlass and operator.

**Rope Hauling on Capstan:** The capstan can be operated independently of the gypsy. Push the locking pawl into the gypsy, release the clutch and place the handle into the off-centre bi-square and wind or engage power.

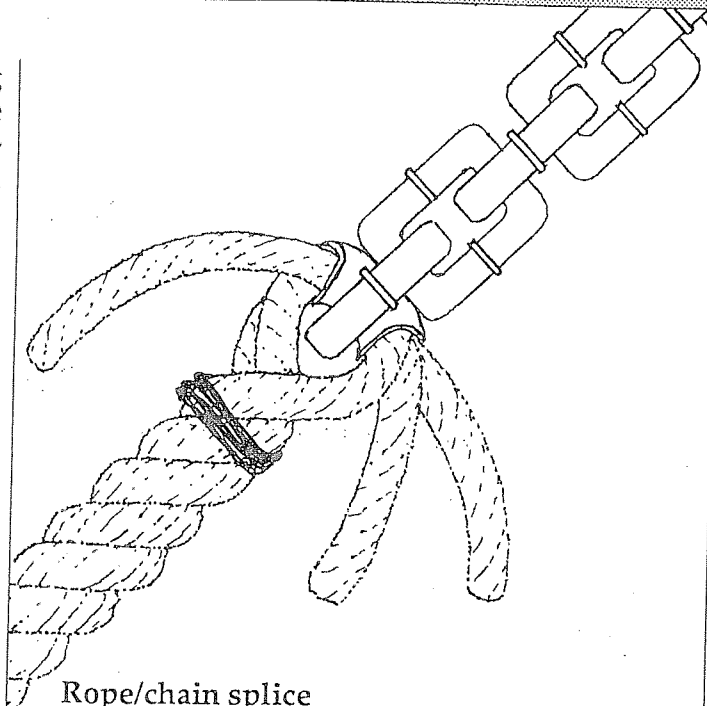

### Rope/chain splice

1. To stop rope unravelling, seize rope 400 mm (16") from rope with whipping twine. Unlay strands.
2. After placing 20 mm (3/4") of heat shrink sleeve tubing through the last link of chain, pass one strand of rope through sleeve and chain from one side and the other two strands of rope from the opposite side (see illustration).
3. While pulling all three strands tight, shrink the sleeve tightly onto the rope using a hairdryer/fan heater or by immersing in boiling water.
4. Remove seizing and complete back splice in normal manner for two full tucks. With a hot knife pare down the three strands by 1/3 and insert two further tucks. Pare down by another 1/3 and finish with two tucks. Cut any remaining tails.

**Electric** Releasing and retrieving the chain with electric models is identical to the operation of the manual models. Always keep well clear of the windlass when releasing or retrieving chain and anchor. Keep fingers, hair and clothing well clear when the windlass is in operation.

Two direction windlasses are now very popular. If the anchor can be positioned on the bow roller, so that it falls as soon as the windlass is reversed, the whole operation can be carried out from aft or fly bridge. Remote switch controls are self centring which stops the windlass when the trigger is removed. Mark the chain at 6 metres (20') and 2 metres (6'6") which will enable you to judge when the anchor is almost up. Go gently with the last few metres of retrieving by letting go of the switch, rather than waiting for the anchor to fly up over the roller, and banging tight, putting excessive load onto the bow roller, windlass and the fore deck!

## SERVICING

A fresh water rinse on all your deck gear after every excursion ensures that all salt deposits and corrosion are kept to a minimum.

Three times a year dismantle the windlass and grease all moving parts with a teflon base grease. Grease the nipple on the deck flange regularly.

# VR/VRC 1200 PARTS & ASSEMBLY

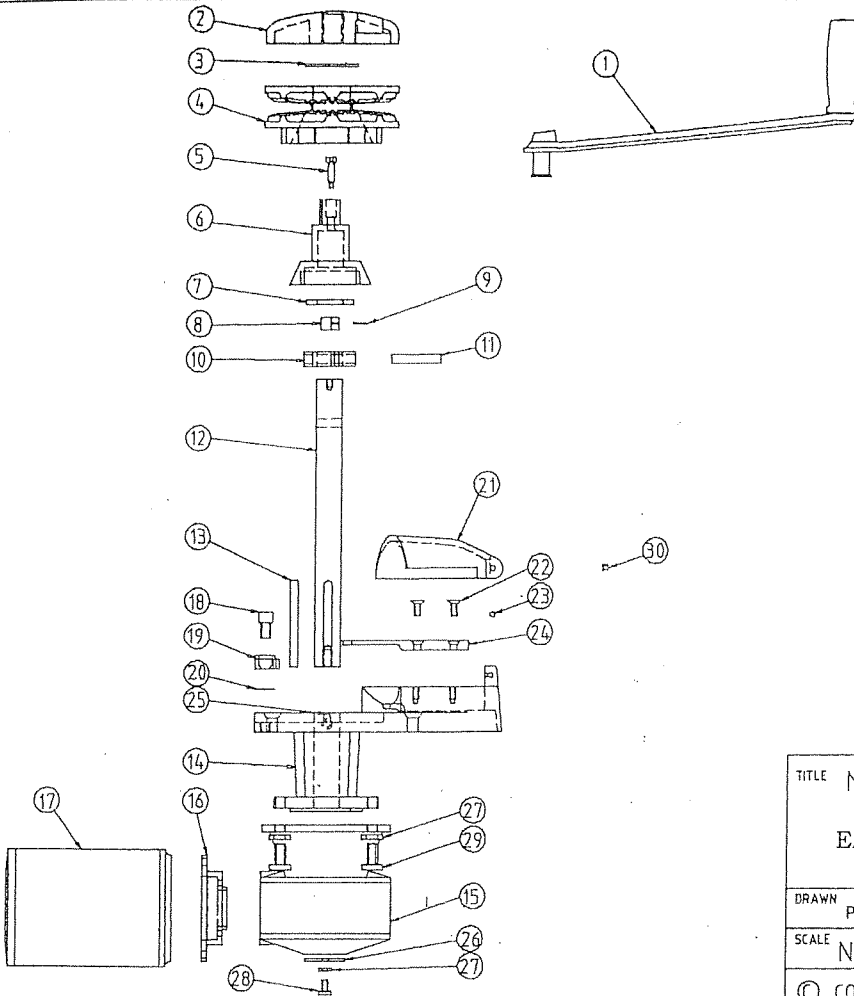

ITEM	PART No.	DESCRIPTION	QTY.
1	0626	HANDLE MUIR	1
2	0461	CAPSTAN TOP "MUIR"	1
3	0710	WASHER	1
4		GYPSY	1
5	1201	SCREW SHD 1/4x3/4x3/16	1
6	1100	SHAFT - CAPSTAN SHORT	1
7	1401	WASHER - NOVASTEEN	1
8	0800	PAWL	2
9	0801	PAWL SPRING	2
10	0500	PAWL RING - SHAFT	1
11	2511	DRIVE PIN - 5/16x2	1
12	1102	SHAFT - VR800	1
13	1801	KEY - 5/16x3 1/4	1
14	1902	BASE - VR800	1
15		GEARBOX	1
16		MOTOR-GEARBOX ADAPTOR	1
17		ELECTRIC MOTOR	1
18	1248	SCREW 3/8x3/4 SHCS	1
19	0802	PAWL - VM/VMC 500	1
20	1421	WASHER - NYLON	1
21	2101	CHAIN COVER - HAWSER	1
22	1200	SCREW 1/4x3/4 CSK MT	2
23	2501	PIN 3/16x1 7/8	1
24	2401	PEELER - HAWSER	1
25	3400	GREASE NIPPLE	1
26	1403	WASHER 2"	1
27	1404	SPRING WASHER 3/8	5
28	1207	SCREW 3/8x3/4 HEX	1
29	1209	SCREW 3/8x1 HEX	4
30	1205	SCREW GRUB 3/16x3/16	1

TITLE MUIR ENGINEERING HOBART  
EASYWEIGH VR-1200

DRAWN P. A.      DATE 10/03/94      DRG No 1161/EX/01  
SCALE N.T.S.      APP *[Signature]*

© COPYRIGHT MUIR ENGINEERING PTY. LTD.

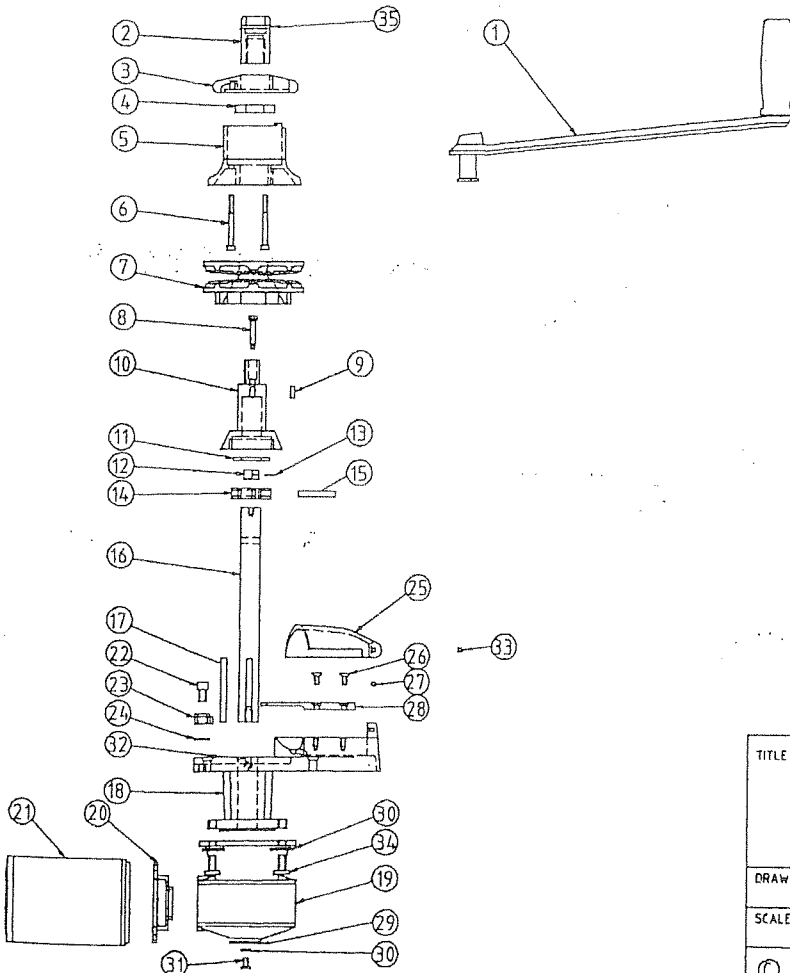

ITEM	PART No.	DESCRIPTION	QTY.
1	0626	HANDLE MUIR	1
2	0724	CLUTCH NUT - VRC1100	1
3	0405	CAPSTAN TOP - "MUIR"	1
4	1405	WASHER - BRZ	1
5	0455	CAPSTAN DRUM - VRC1100	1
6	1325	SCREW 1/4x3 1/2 RHL MT	3
7		GYPSY	1
8	1203	SCREW SHD 1/4x1 1/4x3/16	1
9	1800	KEY 1/4x5/8	1
10	1183	SHAFT CAPSTAN LONG	1
11	1401	WASHER - NOVASTEEN	1
12	0800	PAWL	2
13	0801	PAWL SPRING	2
14	0500	CONE DRIVE RATCHET	1
15	2511	DRIVE PIN 5/16x2	1
16	1102	SHAFT - VR800	1
17	1801	KEY 5/16x3/4	1
18	1902	BASE - VR/VRC 800	1
19		GEARBOX	1
20		MOTOR-GEARBOX ADAPTOR	1
21		ELECTRIC MOTOR	1
22	1248	SCREW 3/8x3/4 SHCS	1
23	0803	PAWL - VM/VMC	1
24	1421	WASHER - NYLON	1
25	2101	CHAIN COVER - EASYWEIGH	1
26	1200	SCREW 1/4x3/4 CSK MT	2
27	2501	PIN 3/16x1 7/8	1
28	2401	CHAIN PEELER - HAWSER	1
29	1403	WASHER 2"	1
30	1404	SPRING WASHER 3/8	5
31	1207	SCREW 3/8x3/4 HEX	1
32	3400	GREASE NIPPLE	1
33	1205	SCREW GRUB 3/16x3/16	1
34	1209	SCREW 3/8x1 HEX	4
35	2306	RING "O"	1

TITLE MUIR ENGINEERING HOBART  
EASYWEIGH VRC-1200

DRAWN P. A.      DATE 10/03/94      DRG No 1171/EX/01  
SCALE      APP *[Signature]*

© COPYRIGHT MUIR ENGINEERING PTY. LTD.

# DIRECTIONS FOR CHANGING VR/VRC 1000/1200 FROM FIXED DRIVE TO RATCHET DRIVE

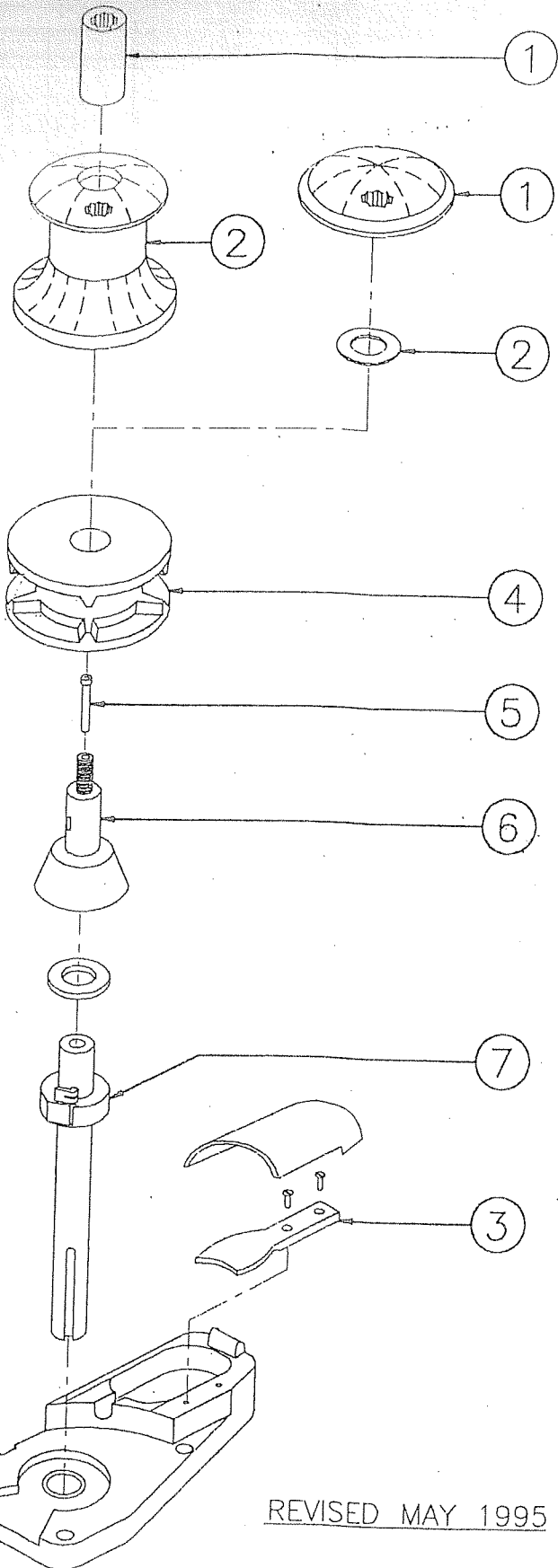

- ① REMOVE CLUTCH NUT (VRC)  
REMOVE CLUTCH CAP (VR)
- ② REMOVE CAPSTAN ASSEMBLY (VRC)  
REMOVE SPACER WASHER (VR)
- ③ REMOVE CHAIN PEELER
- ④ REMOVE GYPSY
- ⑤ REMOVE SHOULDER BOLT  
(USE 1/8" ALLEN KEY)
- ⑥ LIFT OFF DRIVE SHAFT
- ⑦ EXCHANGE PAWLS AS SHOWN BELOW

FOR FIXED DRIVE  
PLACE PAWLS IN SLOTS "A."

FOR RATCHET DRIVE  
PLACE PAWLS IN SLOTS "B"  
WITH SPRINGS.

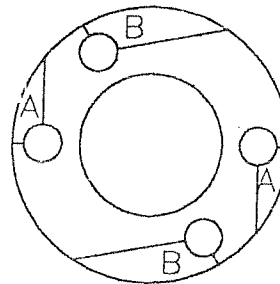

PLACE STRAIGHT LEG OF SPRING  
AGAINST SLIT OF PAWL.

REVISED MAY 1995

# VM/VMC 500 PARTS & ASSEMBLY

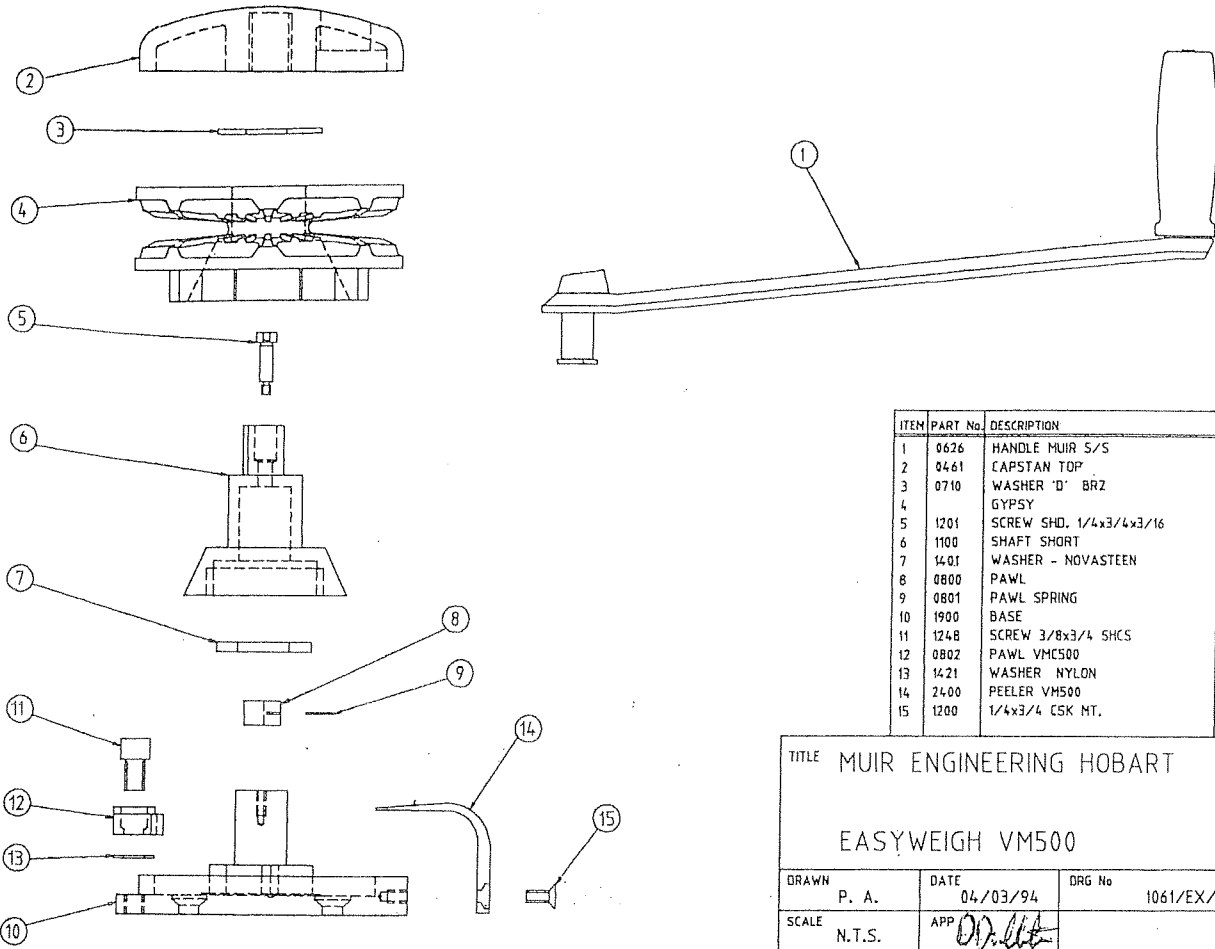

ITEM	PART No.	DESCRIPTION	QTY.
1	0626	HANDLE MUIR S/S	1
2	0461	CAPSTAN TOP	1
3	0710	WASHER 'D' BRZ	1
4		GYPSY	1
5	1201	SCREW SHD. 1/4x3/4x3/16	1
6	1100	SHAFT SHORT	1
7	1401	WASHER - NOVASTEEN	1
8	0800	PAWL	2
9	0801	PAWL SPRING	2
10	1900	BASE	1
11	1248	SCREW 3/8x3/4 SHCS	1
12	0802	PAWL VMC500	1
13	1421	WASHER NYLON	1
14	2400	PEELER VM500	1
15	1200	1/4x3/4 CSK MT.	2

TITLE MUIR ENGINEERING HOBART  
EASYWEIGH VM500

DRAWN P. A. DATE 04/03/94 DRG No 1061/EX/01  
SCALE N.T.S. APP *P.A.*

© COPYRIGHT MUIR ENGINEERING PTY. LTD.

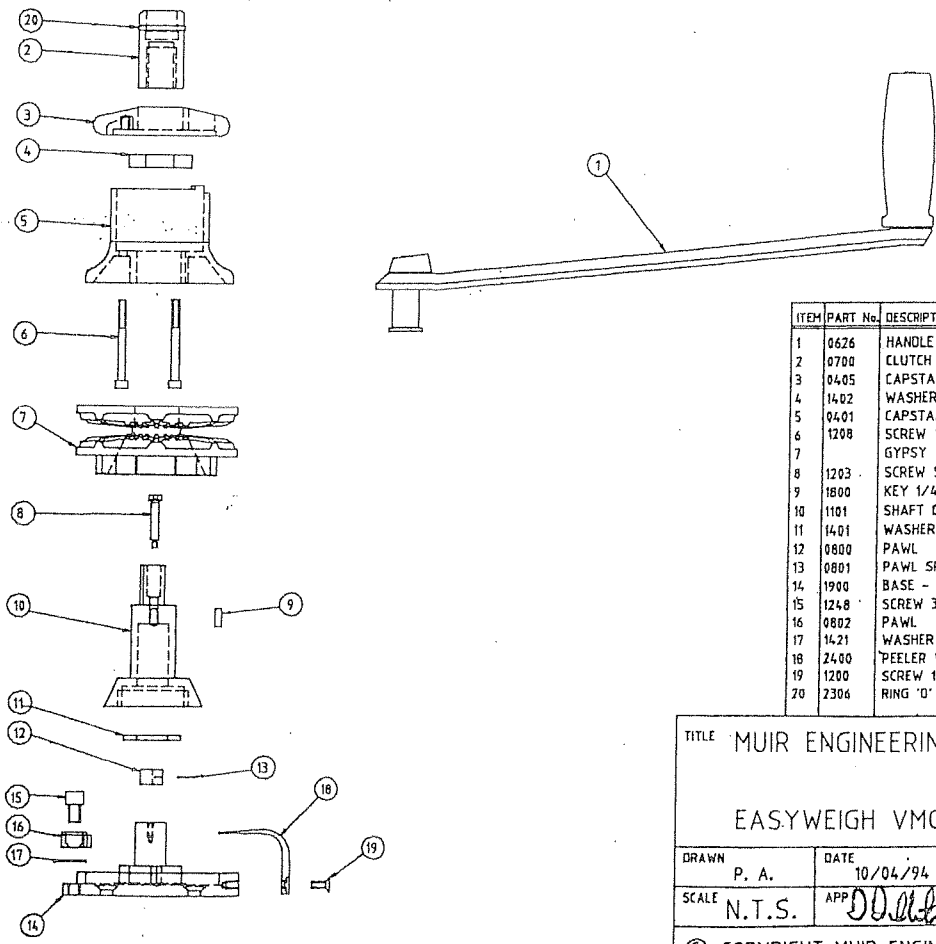

ITEM	PART No.	DESCRIPTION	QTY.
1	0626	HANDLE MUIR S/S	1
2	0700	CLUTCH NUT	1
3	0405	CAPSTAN TOP - 'MUIR' VRC/VMC	1
4	1402	WASHER - BRZ	1
5	0401	CAPSTAN DRUM VMC500/VRC800	1
6	1208	SCREW 1/4x2 1/2 SHCS	3
7		GYPSY	1
8	1203	SCREW SHD 1/4x1 1/4x3/16	1
9	1800	KEY 1/4x5/8	1
10	1101	SHAFT CAPSTAN LONG	1
11	1401	WASHER - NOVASTEEN	1
12	0800	PAWL	2
13	0801	PAWL SPRING	2
14	1900	BASE - VM/VMC 500	1
15	1248	SCREW 3/8x3/4 SHCS	1
16	0802	PAWL	1
17	1421	WASHER - NYLON	1
18	2400	PEELER VM/VMC 500	1
19	1200	SCREW 1/4x3/4 CSK MT.	2
20	2306	RING 'O'	1

TITLE MUIR ENGINEERING HOBART  
EASYWEIGH VMC500

DRAWN P. A. DATE 10/04/94 DRG No 1071/EX/01  
SCALE N.T.S. APP *P.A.*

© COPYRIGHT MUIR ENGINEERING PTY. LTD.

# VM/VMC 500 PARTS & ASSEMBLY

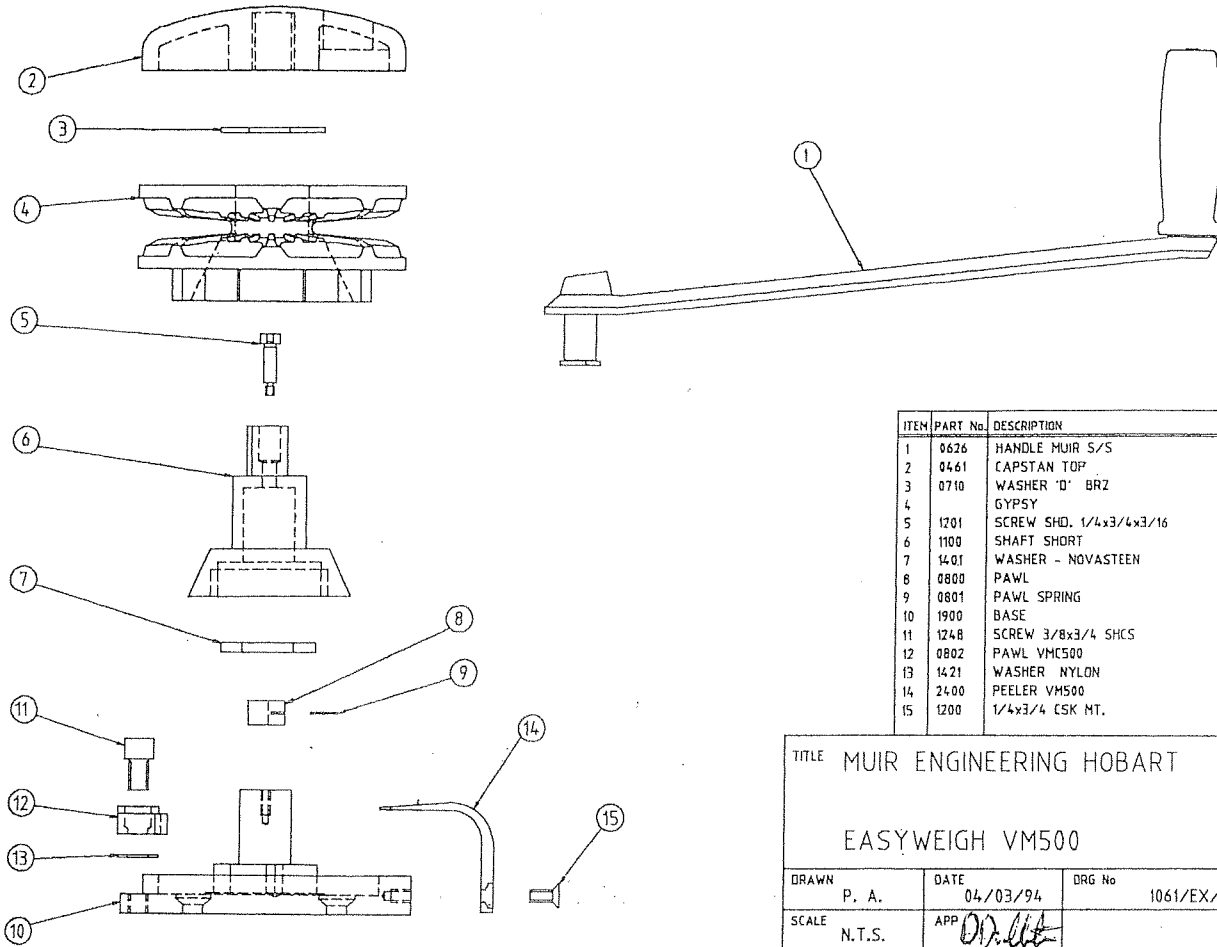

ITEM	PART No.	DESCRIPTION	QTY.
1	0626	HANDLE MUIR S/S	1
2	0461	CAPSTAN TOP	1
3	0710	WASHER 'D' BRZ	1
4		GYPSY	1
5	1201	SCREW SHD. 1/4x3/4x3/16	1
6	1100	SHAFT SHORT	1
7	1401	WASHER - NOVASTEEN	1
8	0800	PAWL	2
9	0801	PAWL SPRING	2
10	1900	BASE	1
11	1248	SCREW 3/8x3/4 SHCS	1
12	0802	PAWL VMC500	1
13	1421	WASHER NYLON	1
14	2400	PEELER VMC500	1
15	1200	1/4x3/4 CSK MT.	2

TITLE MUIR ENGINEERING HOBART

EASYWEIGH VM500

DRAWN	P. A.	DATE	04/03/94	DRG No	1061/EX/01
SCALE	N.T.S.	APP	<i>[Signature]</i>		

© COPYRIGHT MUIR ENGINEERING PTY. LTD.

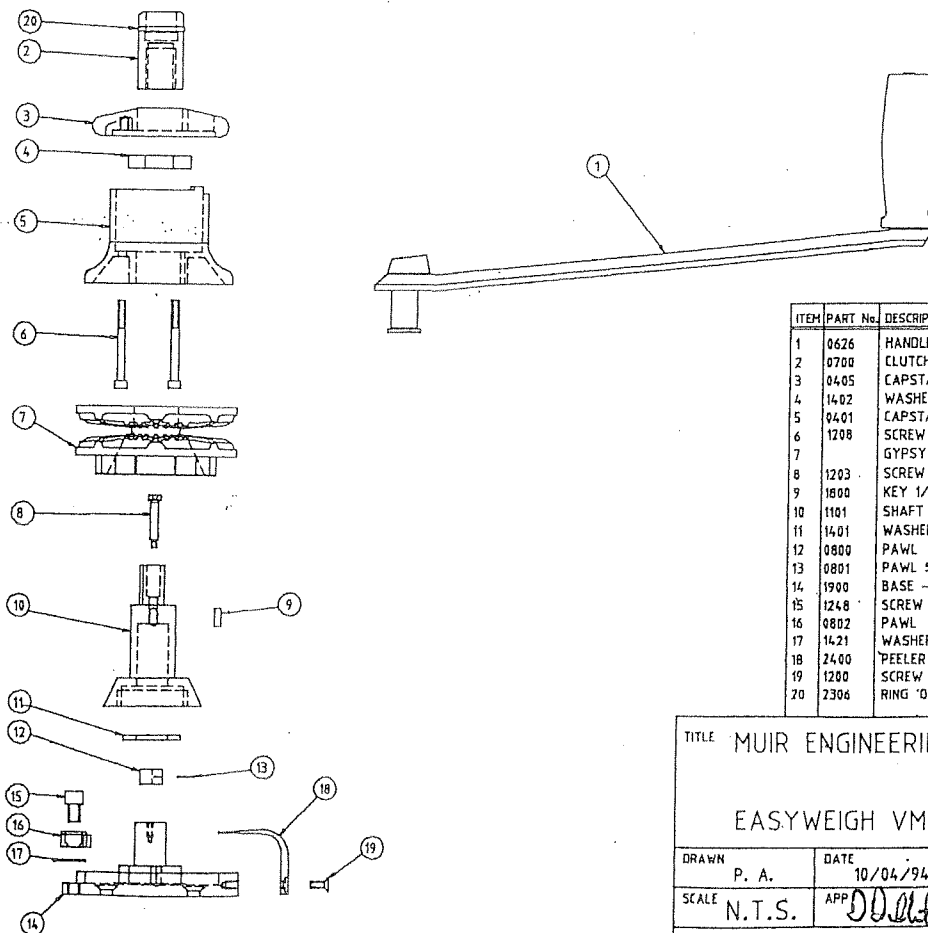

ITEM	PART No.	DESCRIPTION	QTY.
1	0626	HANDLE MUIR S/S	1
2	0700	CLUTCH NUT	1
3	0405	CAPSTAN TOP - 'Muir' VRC/VMC	1
4	1402	WASHER - BRZ	1
5	0401	CAPSTAN DRUM VMC500/VRC800	1
6	1208	SCREW 1/4x2 1/2 SHCS	3
7		GYPSY	1
8	1203	SCREW SHD 1/4x1 1/4x3/16	1
9	1800	KEY 1/4x5/8	1
10	1101	SHAFT CAPSTAN LONG	1
11	1401	WASHER - NOVASTEEN	1
12	0800	PAWL	2
13	0801	PAWL SPRING	2
14	1900	BASE - VM/VMC 500	1
15	1248	SCREW 3/8x3/4 SHCS	1
16	0802	PAWL	1
17	1421	WASHER - NYLON	1
18	2400	PEELER VM/VMC 500	1
19	1200	SCREW 1/4x3/4 CSK MT.	2
20	2306	RING 'O'	1

TITLE MUIR ENGINEERING HOBART

EASYWEIGH VMC500

DRAWN	P. A.	DATE	10/04/94	DRG No	1071/EX/01
SCALE	N.T.S.	APP	<i>[Signature]</i>		

© COPYRIGHT MUIR ENGINEERING PTY. LTD.

# VM/VMC HAWSER 500 PARTS & ASSEMBLY

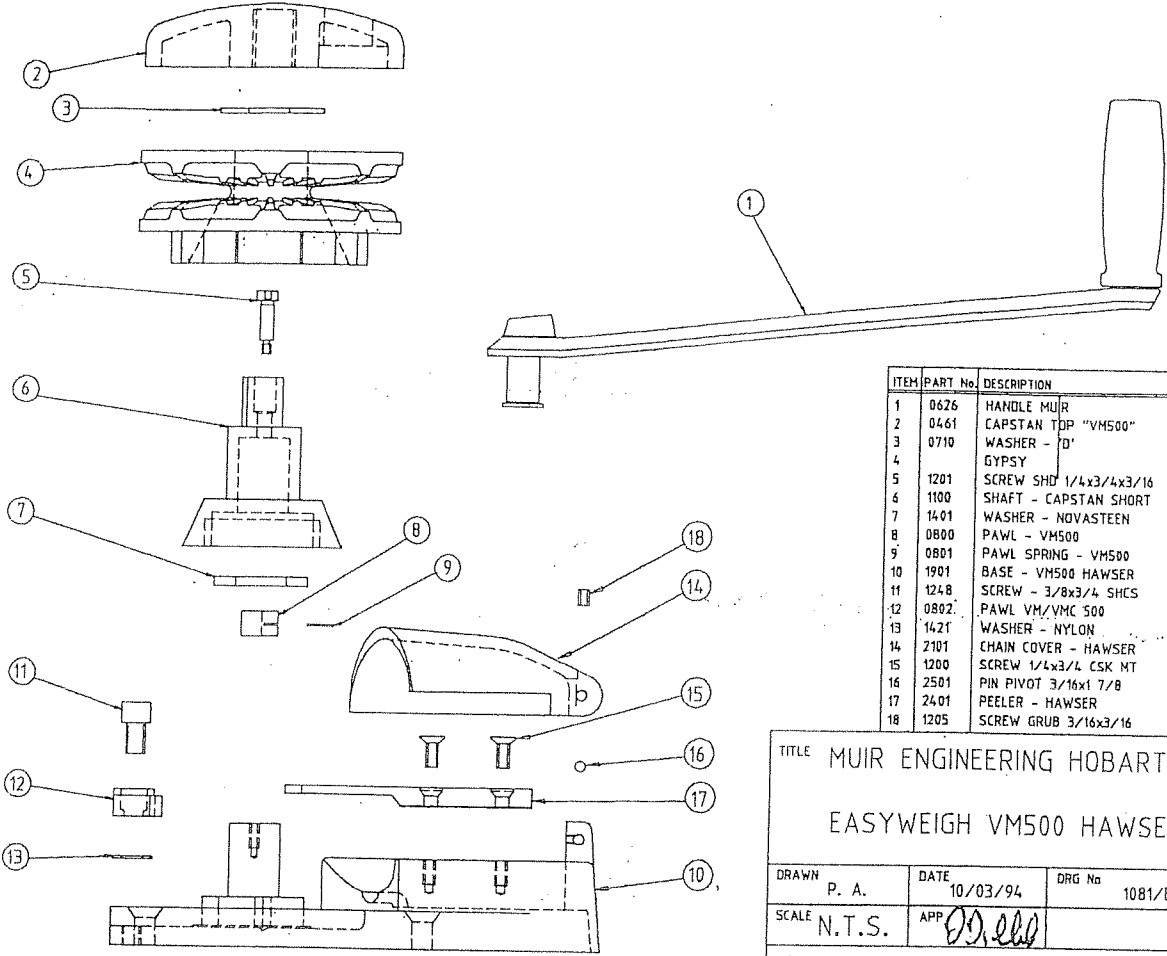

ITEM	PART No.	DESCRIPTION	QTY.
1	0626	HANDLE MUIR	1
2	0461	CAPSTAN TOP "VM500"	1
3	0710	WASHER - 'O'	1
4		GYPSY	1
5	1201	SCREW SHD 1/4x3/4x3/16	1
6	1100	SHAFT - CAPSTAN SHORT	1
7	1401	WASHER - NOVASTEEN	1
8	0800	PAWL - VM500	2
9	0801	PAWL SPRING - VM500	2
10	1901	BASE - VM500 HAWSER	1
11	1248	SCREW - 3/8x3/4 SHCS	1
12	0802	PAWL VM/VMC 500	1
13	1421	WASHER - NYLON	1
14	2101	CHAIN COVER - HAWSER	1
15	1200	SCREW 1/4x3/4 CSK MT	2
16	2501	PIN PIVOT 3/16x1 7/8	1
17	2401	PEELER - HAWSER	1
18	1205	SCREW GRUB 3/16x3/16	1

TITLE MUIR ENGINEERING HOBART  
EASYWEIGH VM500 HAWSER

DRAWN P. A. DATE 10/03/94 DRG No 1081/EX/01  
SCALE N.T.S. APP *[Signature]*

© COPYRIGHT MUIR ENGINEERING PTY. LTD.

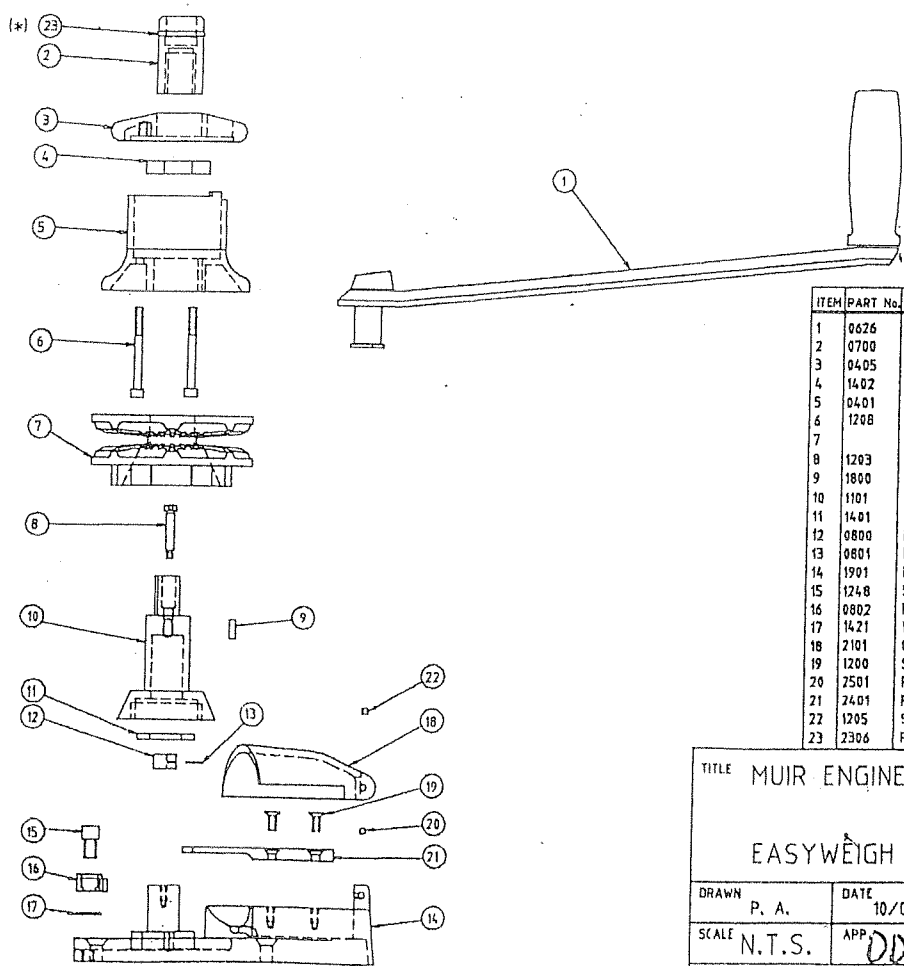

ITEM	PART No.	DESCRIPTION	QTY.
1	0626	HANDLE MUIR	1
2	0700	CLUTCH NUT	1
3	0405	CAPSTAN TOP - "MUIR"	1
4	1402	WASHER - BRZ	1
5	0401	CAPSTAN DRUM	1
6	1208	SCREW 1/4x2 1/2 SHCS	3
7		GYPSY	1
8	1203	SCREW SHD 1/4x1 1/4x3/16	1
9	1800	KEY 1/4x5/8	1
10	1101	RATCHET CONE SHAFT	1
11	1401	WASHER - NOVASTEEN	1
12	0800	PAWL	2
13	0801	PAWL SPRING	2
14	1901	BASE - HAWSER	1
15	1248	SCREW - 3/8x3/4 SHCS	1
16	0802	PAWL - VM/VMC 500	1
17	1421	WASHER - NYLON	1
18	2101	CHAIN COVER	1
19	1200	SCREW 1/4x3/4 CSK MT	2
20	2501	PIVOT PIN - 3/16x1 7/8	1
21	2401	PEELER	1
22	1205	SCREW GRUB 3/16x3/16	1
23	2306	RING 'O'	1

TITLE MUIR ENGINEERING HOBART  
EASYWEIGH VMC500 HAWSER

DRAWN P. A. DATE 10/03/94 DRG No 1091/EX/01  
SCALE N.T.S. APP *[Signature]*

© COPYRIGHT MUIR ENGINEERING PTY. LTD.

# Easy Weigh

S E R I E S

## INSTALLATION

### Below deck installation of VR/VRC 1000 & VR/VRC 1200

The above deck installation of the VR1000 and VRC1000, identical to that of the manual models.

Position the windlass in the best location with the chain hawser forward. Ensure sufficient room to run electric cables to the windlass. Using the template supplied, mark around the drive adaptor disc and cut a 110 mm (4 5/16") hole in the deck.

Mark and cut the chain hawser hole. Follow the installation instructions for the manual models including the underdeck stiffening, deck chamber, alignment, mounting blocks and sealing procedures.

The gearbox and motor can be located in four positions. This new design feature eliminates deck alignment and thickness problems, thus dramatically reducing installation time.

### A CIRCUIT BREAKER MUST BE FITTED TO ENSURE WARRANTY.

The circuit breaker automatically cuts off power to the windlass and protects the electrical system. Manual or automatic units are available.

The Deck Switch is best located either out to port or starboard or directly behind the windlass in a position where it can be easily reached with your foot or knee, preferably where you can see the anchor and chain coming aboard.

The Isolating Switch should be fitted in an accessible position, ideally close to the battery or switches.

Batteries are best located as close to the windlass as possible. If located within 7 m (23') use a cable of minimum 36 spmm, 8 mm (5/16ths) core. For longer runs, 9 - 17 m (30' - 55') use 50 spmm, 10-12 mm (3/8ths - 7/16ths) core. the larger the cable, the greater voltage is delivered to the motor and overheating will not occur. Small diameter cables drop voltage considerably. VRC1000 and VR1000 use 100 amp circuit breaker.

Rotation: Windlasses can be wired for single or dual direction, using one or two deck switches for up and down. Alternatively a remote control solenoid package with a toggle switch or the new touch controller is available.

## WIRING

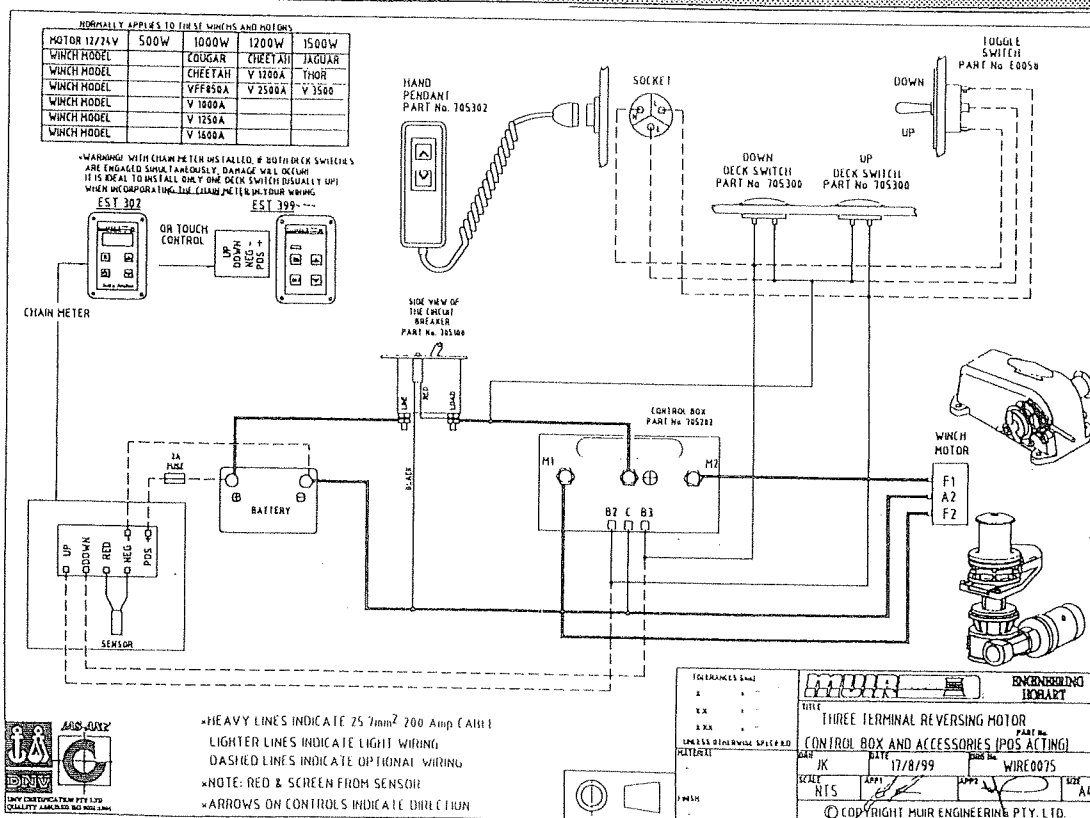

4 HOLES 10mm DIA  
ON 100 PCDIA

BOW

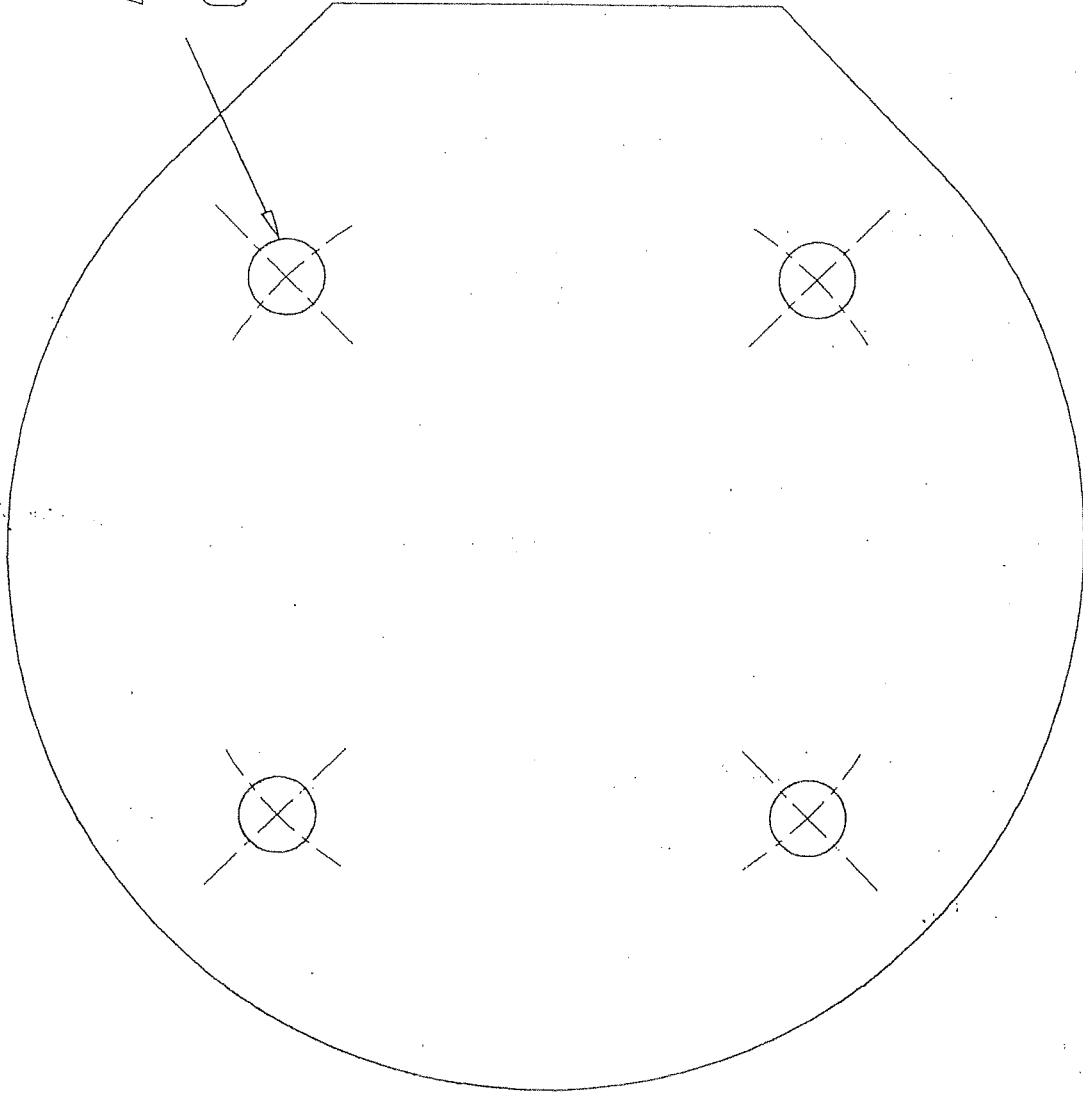

TITLE MUIR ENGINEERING HOBART  
VM 500 / VMC 500  
DECK TEMPLATE

DRAWN	P. A.	DATE	26/3/93	DRG No	1060/MD/01
SCALE	1:1	APP	<i>P.A.</i>		
© COPYRIGHT MUIR ENGINEERING PTY. LTD.					

PHOTOCOPY THIS PAGE FOR TEMPLATE

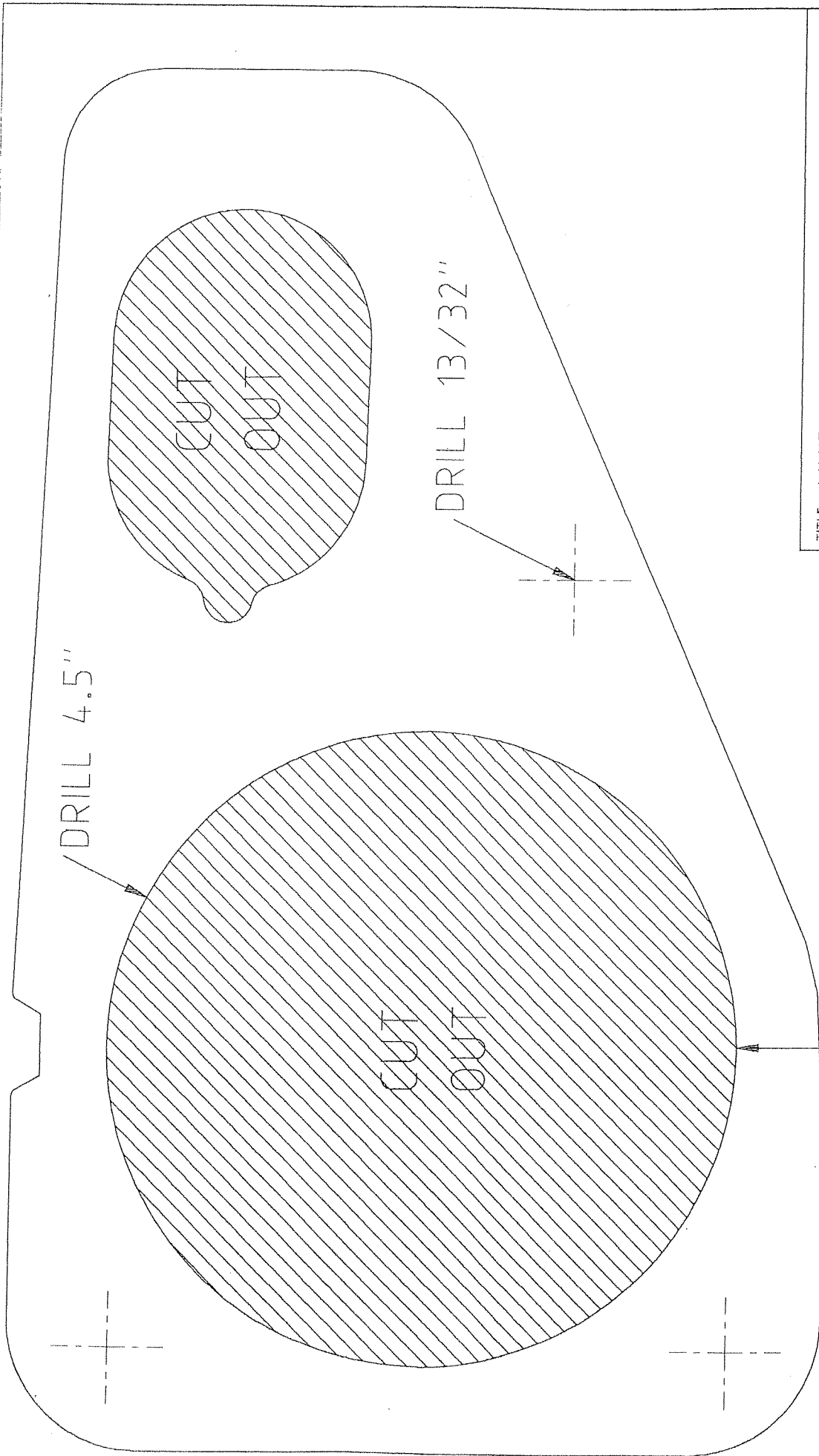

TITLE MUJR ENGINEERING HOBART  
 VM - VMC 500 HAWSER  
 VR/VRC 1000/1200  
 DECK TEMPLATE

DRAWN	S. A.	DATE	25/5/95	DRG No	1090/MD/01
SCALE	1:1	APP	<i>SA</i>		

REMOVE THIS SECTION  
 FOR VR/VRC 1000/1200  
 ONLY

PHOTOCOPY THIS PAGE FOR TEMPLATE

© COPYRIGHT MUJR ENGINEERING PTY. LTD.

# VR/VRC 1000 PARTS & ASSEMBLY

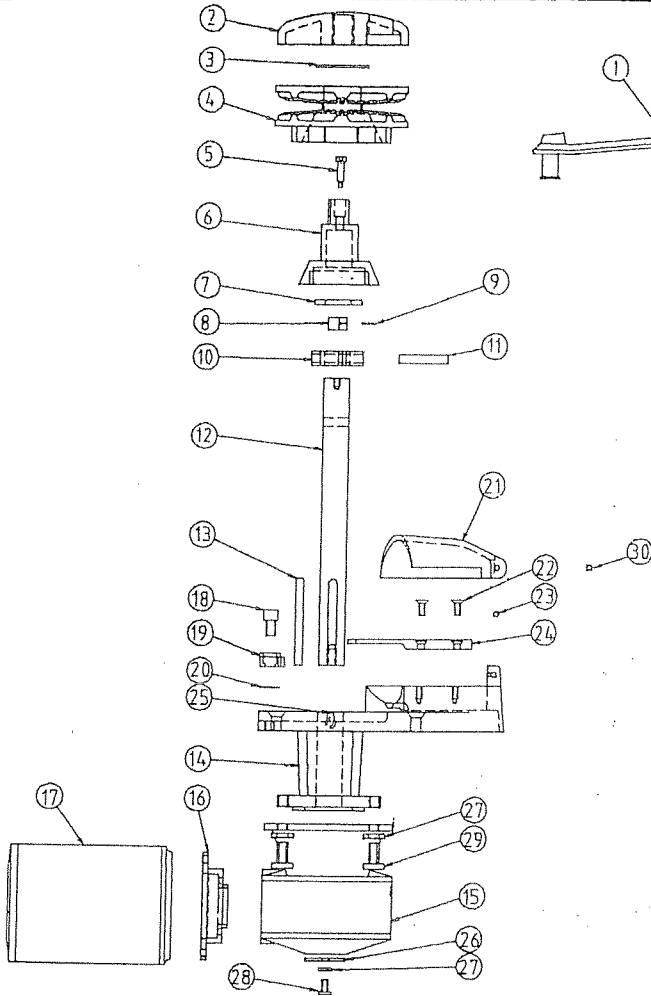

ITEM	PART No.	DESCRIPTION	QTY.
1	0626	HANDLE MUIR	1
2	0461	CAPSTAN TOP - "MUIR"	1
3	0710	WASHER	1
4		GYPST	1
5	1201	SCREW - SHD 1/4x3/4x3/16	1
6	1100	SHAFT - CAPSTAN SHORT	1
7	1401	WASHER - NOVASTEEN	1
8	0800	PAWL	2
9	0801	PAWL SPRING	2
10	0500	PAWL RING - SHAFT	1
11	2511	DRIVE PIN 5/16x2	1
12	1102	SHAFT - VR800	1
13	1801	KEY 5/16x3 1/4	1
14	1902	BASE - VR800	1
15		GEARBOX	1
16		MOTOR-GEARBOX ADAPTOR	1
17		ELECTRIC MOTOR	1
18	1248	SCREW 3/8x3/4 SHCS	1
19	0802	PAWL - VM/VMC 500	1
20	1421	WASHER - NYLON	1
21	2101	CHAIN COVER - HAWSER	1
22	1200	SCREW 1/4x3/4 CSK MT	2
23	2501	PIN - 3/16x1 7/8	1
24	2401	PEELER - HAWSER	1
25	3400	GREASE NIPPLE	1
26	1403	WASHER 2"	1
27	1404	WASHER SPRING 3/8	5
28	1207	SCREW 3/8x3/4 HEX	4
29	1209	SCREW 3/8x1 HEX	4
30	1205	SCREW GRUB 3/16x3/16	1

TITLE MUIR ENGINEERING HOBART  
EASYWEIGH VR-1000

DRAWN P. A.	DATE 10/03/94	DRG No 1141/EX/01
SCALE N.T.S.	APP <i>W. O'Neil</i>	

© COPYRIGHT MUIR ENGINEERING PTY. LTD.

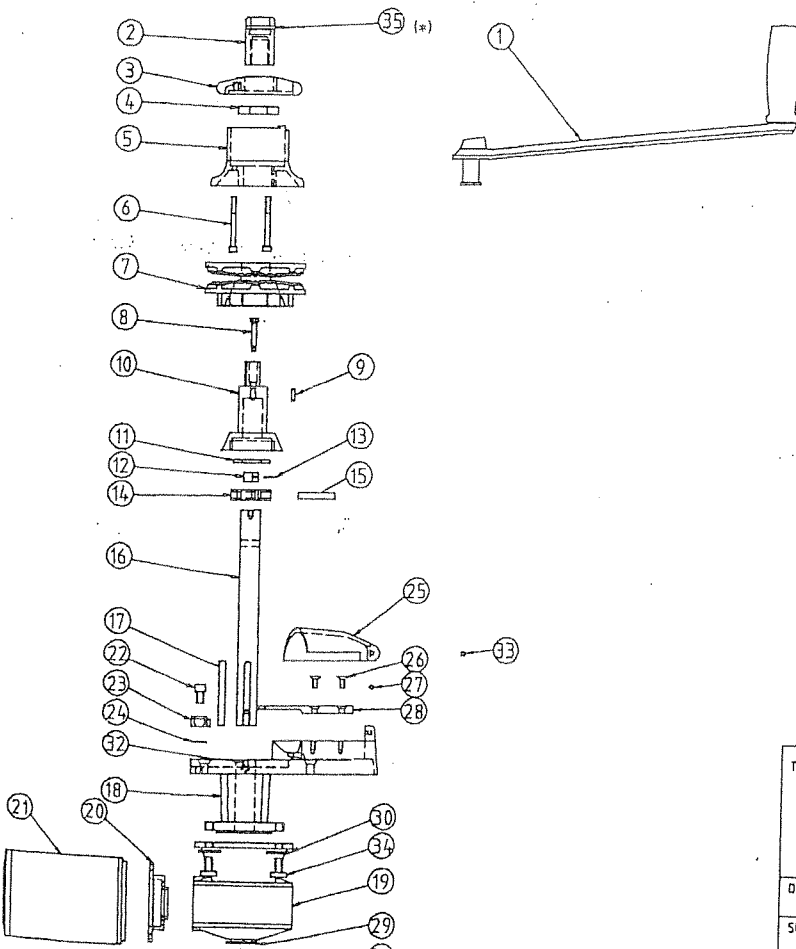

ITEM	PART No.	DESCRIPTION	QTY.
1	0626	HANDLE MUIR	1
2	0700	CLUTCH NUT	1
3	0405	CAPSTAN TOP	1
4	1405	WASHER - BR2	1
5	0401	CAPSTAN DRUM	1
6	1208	SCREW 1/4x2 1/2 SHCS	3
7		GYPST	1
8	1203	SCREW SHD 1/4x1 1/4x3/16	1
9	1800	KEY 1/4x5/8	1
10	1101	SHAFT CAPSTAN LONG	1
11	1401	WASHER - NOVASTEEN	1
12	0800	PAWL	2
13	0801	PAWL SPRING	2
14	0500	CONE DRIVE RATCHET	1
15	2511	DRIVE PIN 5/16x2	1
16	1102	SHAFT - VRC 800	1
17	1801	KEY 5/16x3 1/4	1
18	1902	BASE - VR800	1
19		GEARBOX	1
20		MOTOR-GEARBOX ADAPTOR	1
21		ELECTRIC MOTOR	1
22	1248	SCREW 3/8x3/4 SHCS	1
23	0802	PAWL - VM/VMC	1
24	1421	WASHER - NYLON	1
25	2101	CHAIN COVER - EASYWEIGH	1
26	1200	SCREW 1/4x3/4 CSK MT	2
27	2501	PIN 3/16x1 7/8	1
28	2401	CHAIN PEELER - HAWSER	1
29	1403	WASHER 2"	1
30	1404	SPRING WASHER 3/8	5
31	1207	SCREW 3/8x3/4 HEX	1
32	3400	GREASE NIPPLE	1
33	1205	SCREW GRUB 3/16x3/16	1
34	1209	SCREW 3/8x1	4
35	2306	RING 'O'	1

TITLE MUIR ENGINEERING HOBART  
EASYWEIGH VRC-1000

DRAWN P. A.	DATE 10/03/94	DRG No 1151/EX/01
SCALE N.T.S.	APP <i>W. O'Neil</i>	

# VR/VRC 1000 PARTS & ASSEMBLY (ROUND BASE)

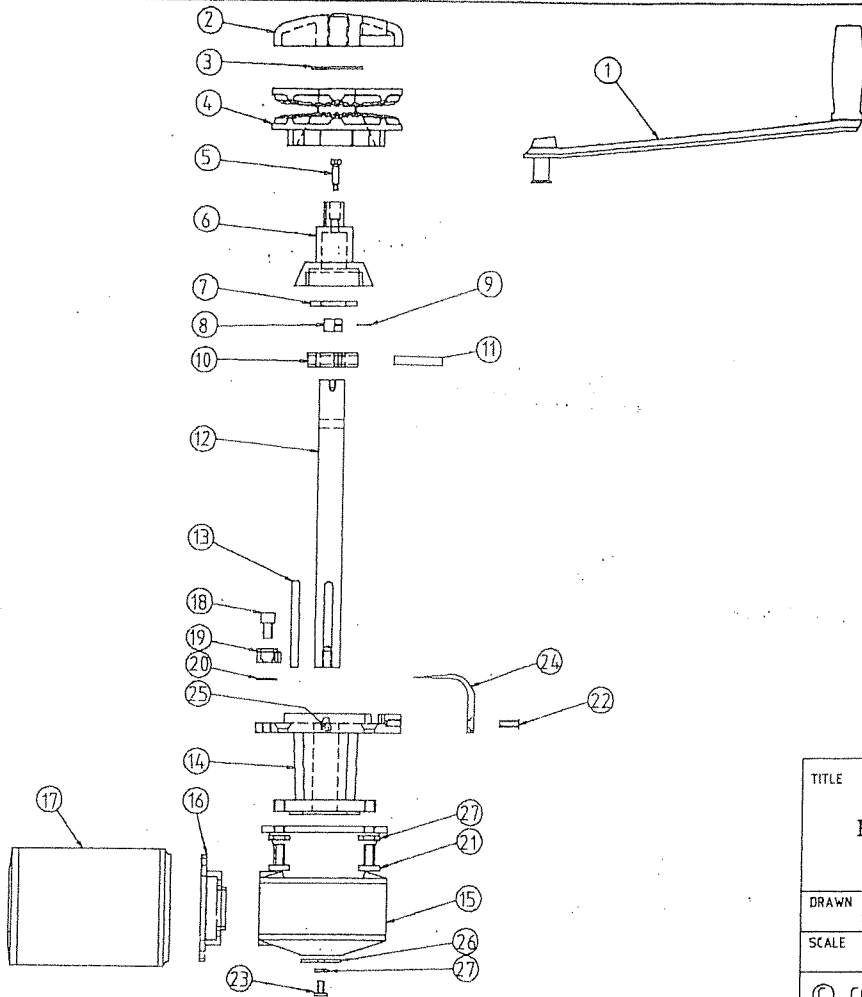

ITEM	PART No.	DESCRIPTION	QTY.
1	0626	HANDLE MUIR	1
2	0461	CAPSTAN TOP - "MUIR"	1
3	0710	WASHER	1
4		GYPSY	1
5	1201	SCREW - SHD 1/4x3/4x3/16	1
6	1100	SHAFT - CAPSTAN SHORT	1
7	1401	WASHER - NOVASTEEN	1
8	0800	PAWL	2
9	0801	PAWL SPRING	2
10	0500	PAWL RING - SHAFT	1
11	2511	DRIVE PIN 5/16x2	1
12	1102	SHAFT - VR800	1
13	1801	KEY 5/16x3 1/4	1
14	1928	BASE - VR800	1
15		GEARBOX	1
16		MOTOR-GEARBOX ADAPTOR	1
17		ELECTRIC MOTOR	1
18	1248	SCREW 3/8x3/4 SHCS	1
19	0802	PAWL - VM/VMC 500	1
20	1421	WASHER - NYLON	1
21	1209	SCREW 3/8x1 HEX	4
22	1200	SCREW 1/4x3/4 CSK MT	2
23	1207	SCREW 3/8x3/4 HEX	1
24	2400	PEELER	1
25	3400	GREASE NIPPLE	1
26	1403	WASHER 2"	1
27	1404	WASHER SPRING 3/8	5

TITLE MUIR ENGINEERING HOBART  
EASYWEIGH VR-1000  
ROUND BASE

DRAWN P. A.	DATE 10/03/94	DRG No 1141/EX/02
SCALE	APP <i>Doyle</i>	

© COPYRIGHT MUIR ENGINEERING PTY. LTD.

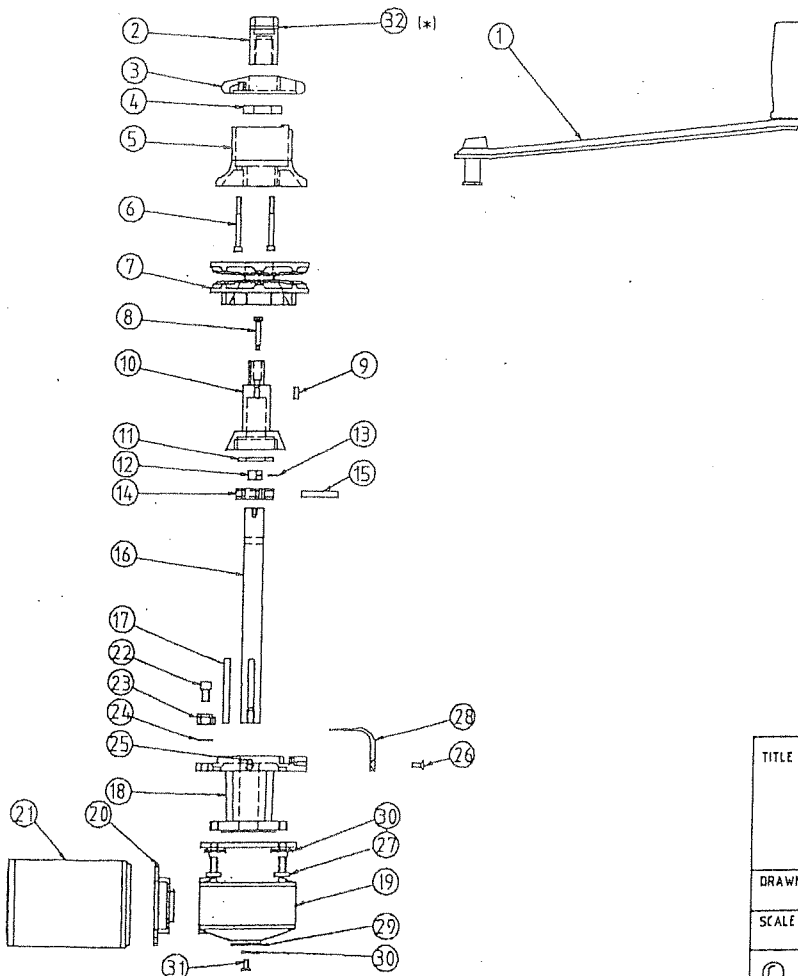

ITEM	PART No.	DESCRIPTION	QTY.
1	0626	HANDLE MUIR	1
2	0700	CLUTCH NUT	1
3	0405	CAPSTAN TOP	1
4	1405	WASHER - BRZ	1
5	0401	CAPSTAN DRUM	1
6	1208	SCREW 1/4x2 1/2 SHCS	3
7		GYPSY	1
8	1203	SCREW SHD 1/4x1 1/4x3/16	1
9	1800	KEY 1/4x5/8	1
10	1101	SHAFT CAPSTAN LONG	1
11	1401	WASHER - NOVASTEEN	1
12	0800	PAWL	2
13	0801	PAWL SPRING	2
14	0500	CONE DRIVE RATCHET	1
15	2511	DRIVE PIN 5/16x2	1
16	1102	SHAFT - VRC 800	1
17	1801	KEY 5/16x3 1/4	1
18	1928	BASE - VR800 ROUND	1
19		GEARBOX	1
20		MOTOR-GEARBOX ADAPTOR	1
21		ELECTRIC MOTOR	1
22	1248	SCREW 3/8x3/4 SHCS	1
23	0802	PAWL - VM/VMC	1
24	1421	WASHER - NYLON	1
25	3400	GREASE NIPPLE	1
26	1200	SCREW 1/4x3/4 CSK MT	2
27	1209	SCREW 3/8x1	4
28	2400	CHAIN PEELER	1
29	1403	WASHER 2"	1
30	1404	SPRING WASHER 3/8	5
31	1207	SCREW 3/8x3/4 HEX	1
32	2306	RING 'O'	1

TITLE MUIR ENGINEERING HOBART  
EASYWEIGH VRC-1000  
ROUND BASE

DRAWN P. A.	DATE 10/03/94	DRG No 1151/EX/02
SCALE N.T.S.	APP <i>Doyle</i>	

© COPYRIGHT MUIR ENGINEERING PTY. LTD.

4 holes  $\phi 10$  on 122 PCD

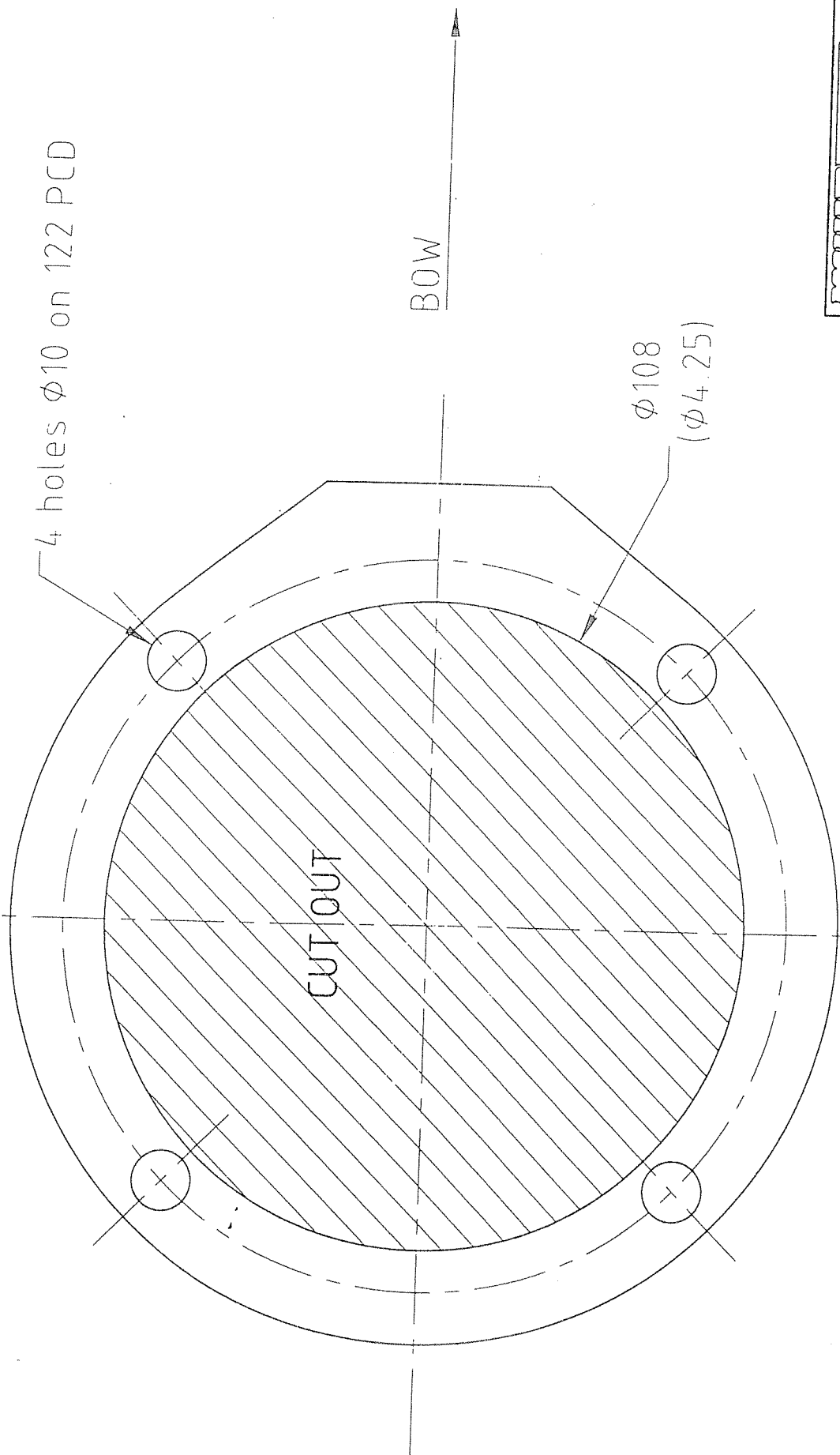

		ENGINEERING HOBART	
TITLE VR/VRC 1000/1200 ROUND BASE DECK TEMPLATE			
PART No.			
DRN	PA	DATE	DRG No
SCALE	1:1	26/03/93	VR1000 EW DT
		APPT	APP?
		S. Amie	
			SIZE A4
© COPYRIGHT MUIR ENGINEERING PTY. LTD.			

TOLERANCES (mm)	
X.	±
X.X	±
X.XX	±
UNLESS OTHERWISE SPECIFIED	
MATERIAL	
FINISH	

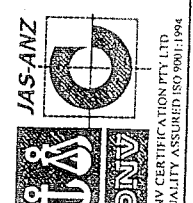
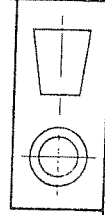

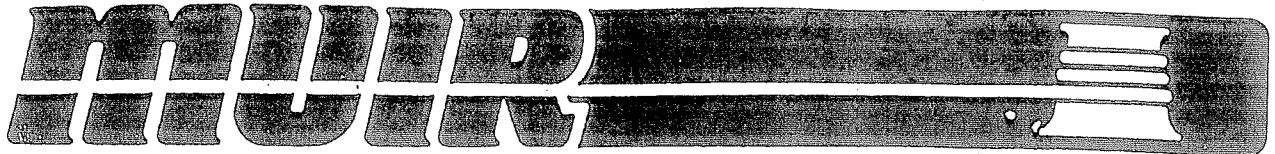

## WINCHES & WINDLASSES AUSTRALIA

### ROPE/CHAIN & ROPE ONLY GYPSIES

1. Must use soft 3 strand nylon anchor line. Various makes are available preferably the special treated line which doesn't harden.
2. Medium and hard lay line is unsatisfactory, and will not pull or coil correctly.
3. Line must remain soft and not harden after used in sea water.
4. Testing needs to be done with the line wet as in actual working conditions.
5. Freefalls R500/R1000 run 10, 12, 14, 16mm (3/8", 1/2", 9/16", 5/8") line.  
Note: 16mm (5/8 line) uses special 16mm jaw (10mm being plaited rope only).
6. Easyweigh 500VM, VMC & Hawsers, VR/VRC1000, VR/VRC1200 8 & 10mm (5/16") Gypsy run 14, 16mm (9/16, 5/8") rope 10mm (3/8") Gypsy runs 14, 16, 18mm (9/16, 5/8 & 11/16") rope, 13mm (1/2") Gypsy runs 18mm & 20mm (11/16, 3/4) rope.
7. Easyweigh 500VM, VMC & Hawsers, VR/VRC1000, VR/VRC1200 8 & 10mm (5/16, 3/8") Gypsies run 12, 14 & 16mm (1/2, 9/16, 5/8") rope, 6mm (1/4") Gypsy runs 10, 12 & 14mm (3/8, 1/2, 9/16") rope.
8. Compact H600 & H700 run 12mm (1/2") line only on (1/4") 6mm and 7mm Gypsies imperial, metric, BBB, Hi Test, DIN.

NOTE: VFF850 Model Freefall runs all ropes as item 7.

Other rope and size combinations do run however the rope diameter in the above are matched up to the chain and boat sizes.

NOTE: Not all sizes of Muir Chain Gypsies are available in Rope/Chain combinations only "popular" Metric and Imperial, BBB Models & DIN the "Easyweigh" design and new 1995 models.

Horizontal models HRV770, HR1100, HR1600, HM770, HM1200 are mostly available in Rope/Chain Gypsies and we expect by end of 1995 all to be available in popular sizes by using Easyweigh Gypsies for minimum parts and inventory, by changing ratchets and pawls design on Gypsies.

Due to ongoing research and development we reserve the right to change specification without notice.

JOHN MUIR  
21.3.1995

**Warranty  
Limited for period of Three years  
(First Owner)**

We warrant each new product manufactured by us to be free from defects in material and workmanship for a period of 3 years (first Owner).

This warranty shall become effective only upon receipt of a completed warranty registration, which shall identify the product so registered by serial number. This warranty shall remain in effect for a period of three(3) years from the date of purchase. For vessels in charter or hire the warranty is one (1) year due to various operators and overloading which may occur.

**Conditions**

While this warranty applies to defects in material and workmanship, it does not apply to:

- Normal worn parts or to damage caused by neglect, lack of maintenance, accident or improper service/installation or service by persons other than an authorised Muir representative.
- Muir shall not be responsible for failures due to products being used in applications that they are not intended for, or exceed the products performance specifications.
- For warranty claim, defective product must be returned to Muir for inspection.
- Muir will not be responsible for freight charges, removal or installation labour on warranty claims.
- Damage due to unsatisfactory storage or use of equipment prior to installation in the approved/intended manner.

**Exclusions**

Warranty is limited to twelve months for :

- Electric motors / controls / equipment
- Hydraulic pumps / controls / valves
- Weather seals
- Use on charter/hire/commercial boats

All incidental and/or consequential damages are excluded from this warranty. Warranties of merchantability and fitness are excluded from this warranty. Implied warranties are limited to the life of this warranty. Some countries do not allow limitations on how long an implied warranty lasts or the exclusion or limitation of incidental or consequential damages, so the above may not apply to you.

We reserve the right to improve the design or materials used on any product without assuming any obligation to modify any product previously manufactured or used.

**Liability**

Muir Engineering liability under this warranty shall be to the exclusion of all other warranties or liabilities (to the extent permitted bylaw). In particular (but without limitation):

Muir Engineering shall not be liable for:

Any indirect or consequential loss including (without limitation) any loss of anticipated profits, damage to reputation or goodwill, loss of expected future business, damages, costs or expenses payable to any third party or any other indirect losses. Any damage to yachts or equipment. Death or personal injury (unless caused by Muir Engineering negligence).

**WARRANTY REGISTRATION CARD**

**Return To**  
MUIR ENGINEERING PTY. LTD.  
100 Browns Rd, Kingston  
Tasmania, Australia, 7050

**WARRANTY VOID UNLESS CIRCUIT  
BREAKER OR RELIEF VALVE FITTED**

Customer Name :	Address / Contact :
Winch Model :	Serial No :
Date of Purchase :	
Supplier Name :	Address :

## Warranty Limited for period of Three years (First Owner)

We warrant each new product manufactured by us to be free from defects in material and workmanship for a period of 3 years (first Owner).

This warranty shall become effective only upon receipt of a completed warranty registration, which shall identify the product so registered by serial number. This warranty shall remain in effect for a period of three (3) years from the date of purchase. For vessels in charter or hire the warranty is one (1) year due to various operators and overloading which may occur.

### Conditions

While this warranty applies to defects in material and workmanship, it does not apply to:

- Normal worn parts or to damage caused by neglect, lack of maintenance, accident or improper service/ installation or service by persons other than an authorised Muir representative.
- Muir shall not be responsible for failures due to products being used in applications that they are not intended for, or exceed the products performance specifications.
- For warranty claim, defective product must be returned to Muir for inspection.
- Muir will not be responsible for freight charges, removal or installation labour on warranty claims.
- Damage due to unsatisfactory storage or use of equipment prior to installation in the approved/intended manner.

### Exclusions

Warranty is limited to twelve months for :

- Electric motors / controls / equipment
- Hydraulic pumps / controls / valves
- Weather seals
- Use on hire boats

All incidental and/or consequential damages are excluded from this warranty. Warranties of merchantability and fitness are excluded from this warranty. Implied warranties are limited to the life of this warranty. Some countries do not allow limitations on how long an implied warranty lasts or the exclusion or limitation of incidental or consequential damages, so the above may not apply to you.

We reserve the right to improve the design or materials used on any product without assuming any obligation to modify any product previously manufactured or used.



## WARRANTY REGISTRATION CARD

Return To  
MUIR ENGINEERING PTY. LTD.  
100 Browns Rd, Kingston  
Tasmania, Australia, 7050

**WARRANTY VOID UNLESS CIRCUIT  
BREAKER OR RELIEF VALVE FITTED**

Customer Name :	Address / Contact :
Winch Model :	Serial No :
Date of Purchase :	
Supplier Name :	Address :

NORMALLY APPLIES TO THESE WINCHS AND MOTORS

MOTOR	12/24V	500W	1000W	1200W	1500W
WINCH MODEL			COUGAR	CHEETAH	JAGUAR
WINCH MODEL			CHEETAH	V 1200A	THOR
WINCH MODEL			VFFB50A	V 2500A	V 3500
WINCH MODEL			V 1000A		
WINCH MODEL			V 1250A		
WINCH MODEL			V 1600A		

\*WARNING! WITH CHAIN METER INSTALLED, IF BOTH DECK SWITCHES ARE ENGAGED SIMULTANEOUSLY, DAMAGE WILL OCCUR! IT IS IDEAL TO INSTALL ONLY ONE DECK SWITCH (USUALLY UP) WHEN INCORPORATING THE CHAIN METER IN YOUR WIRING.

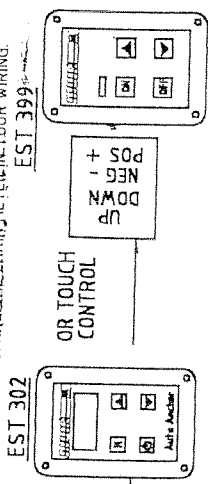

CHAIN METER

SIDE VIEW OF THE CIRCUIT BREAKER PART No. 705100

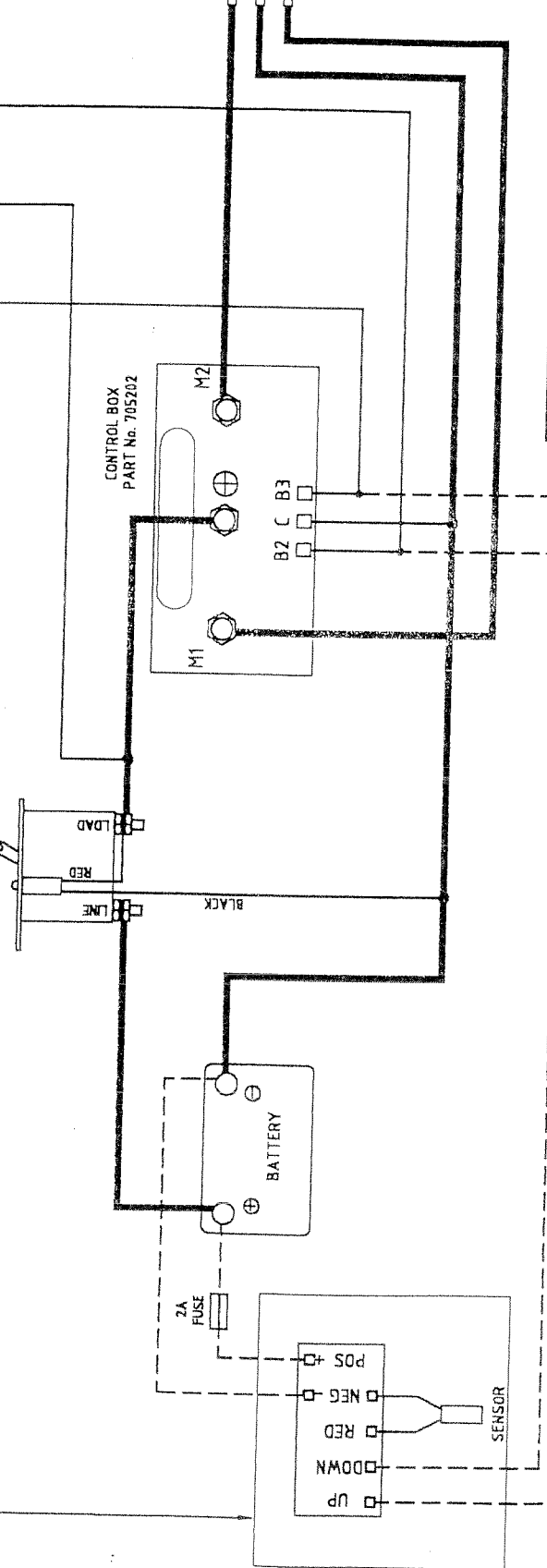
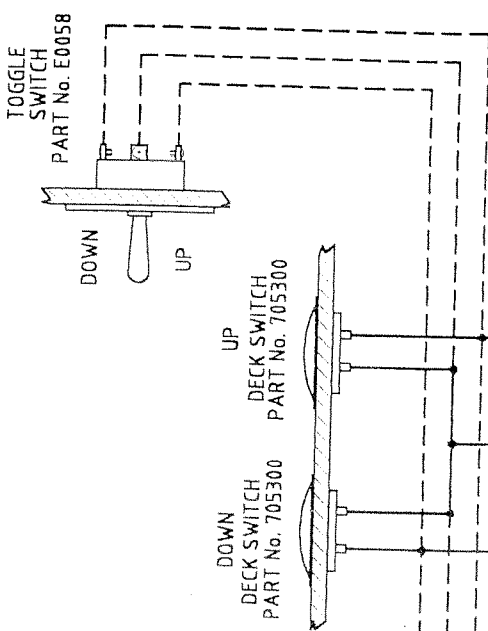
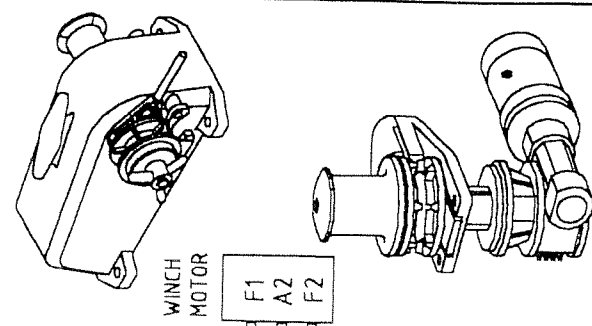

\*HEAVY LINES INDICATE 25.7mm<sup>2</sup> 200 Amp CABLE.  
 LIGHTER LINES INDICATE LIGHT WIRING.  
 DASHED LINES INDICATE OPTIONAL WIRING.  
 \*NOTE: RED & SCREEN FROM SENSOR.  
 \*ARROWS ON CONTROLS INDICATE DIRECTION

**ENGINEERING HOBART**

TOLERANCES (mm)  
 X. ±  
 X.X ±  
 X.XX ±  
 UNLESS OTHERWISE SPECIFIED

MATERIAL FINISH

DATE 17/8/99  
 APP1  
 APP2  
 SCALE NTS  
 DRN JK  
 WIRE No. WIRE0075

TITLE  
**ENGINEERING HOBART**  
 THREE TERMINAL REVERSING MOTOR  
 PART No. CONTROL BOX AND ACCESSORIES (POS ACTING)

SIZE A4

© COPYRIGHT MUIR ENGINEERING PTY. LTD.



NORMALLY APPLIES TO THESE WINCHES

# H700, VR/VRC 850, VR/VRC 500 & R-500

\*WARNING! WITH CHAIN METER INSTALLED, IF BOTH DECK SWITCHES ARE ENGAGED SIMULTANEOUSLY, DAMAGE WILL OCCUR! IT IS IDEAL TO INSTALL ONLY ONE DECK SWITCH (USUALLY UP) WHEN INCORPORATING THE CHAIN METER IN YOUR WIRING.

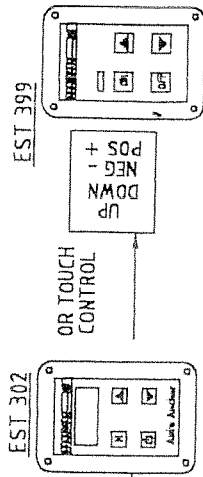

CHAIN METER

SIDE VIEW OF THE CIRCUIT BREAKER PART No. 705100

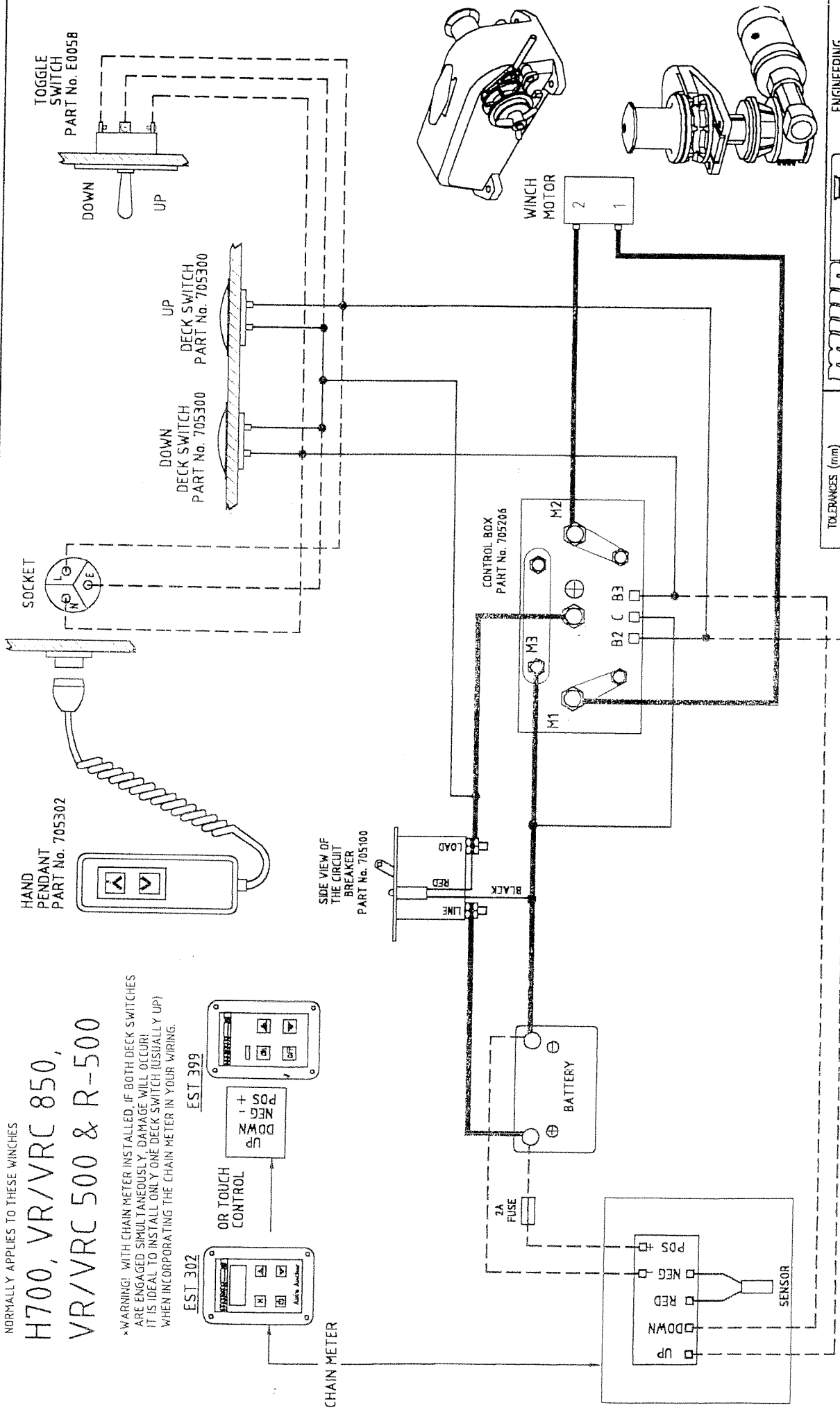

×HEAVY LINES INDICATE 7.91mm<sup>2</sup> 200 Amp CABLE.

LIGHTER LINES INDICATE LIGHT WIRING.

DASHED LINES INDICATE OPTIONAL WIRING.

×NOTE: RED & SCREEN FROM SENSOR.

×ARROWS ON CONTROLS INDICATE DIRECTION

TOLERANCES (mm)
X. ±
X.X ±
X.XX ±
UNLESS OTHERWISE SPECIFIED
UNIVERSAL

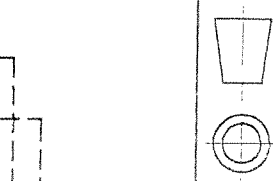

ENGINEERING HOBART	
TITLE	TWO WIRE REVERSING MOTOR (600W)
DRN	CONTROL BOX (pos acting)
J/K	DATE 18/8/99
SCALE NTS	APP'D [Signature]
DRG No.	WIRE0076
SIZE	A4
© COPYRIGHT MUJR ENGINEERING PTY. LTD.	

JAS ANZ

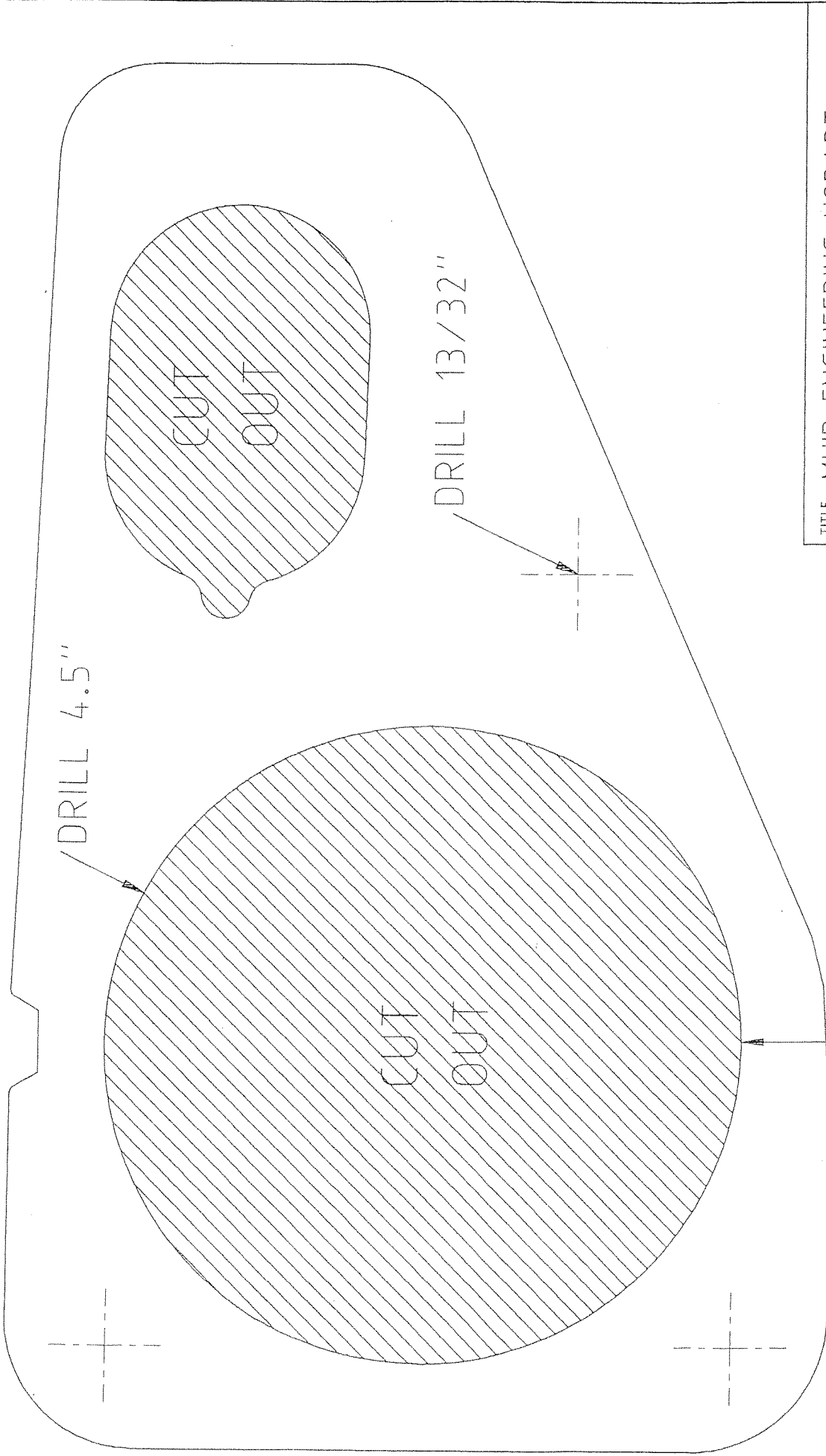

TITLE  
 MUIR ENGINEERING HOBART  
 VM - VMC 500 HAWSER  
 VR/VRC 1000/1200  
 DECK TEMPLATE

DRAWN	S. A.	DATE	25/5/95	DRG No	1090/MD/01
SCALE	1:1	APP	<i>SA</i>		

REMOVE THIS SECTION  
 FOR VR/VRC 1000/1200  
 ONLY

PHOTOCOPY THIS PAGE FOR TEMPLATE

© COPYRIGHT MUIR ENGINEERING PTY. LTD.

4 holes  $\phi 10$  on 122 PCD

BOW

$\phi 108$   
( $\phi 4.25$ )

CUT OUT

		ENGINEERING HOBART	
TITLE VR/VRC 1000/1200 ROUND BASE DECK TEMPLATE			
PART No.		DRG No.	VR1000 EW DT
URN	PA	DATE	APP1
SCALE	1:1	26/03/93	APP2
MATERIAL		UNLESS OTHERWISE SPECIFIED	
FINISH		A. Annie	
© COPYRIGHT MUIR ENGINEERING PTY. LTD.			

TOLERANCES (mm)	
X	±
X.X	±
X.XX	±
UNLESS OTHERWISE SPECIFIED	
MATERIAL	
FINISH	

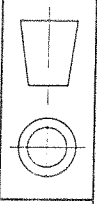

JAS-ANZ 

DNV 

DNV CERTIFICATION PTY LTD  
QUALITY ASSURED ISO 9001:1994

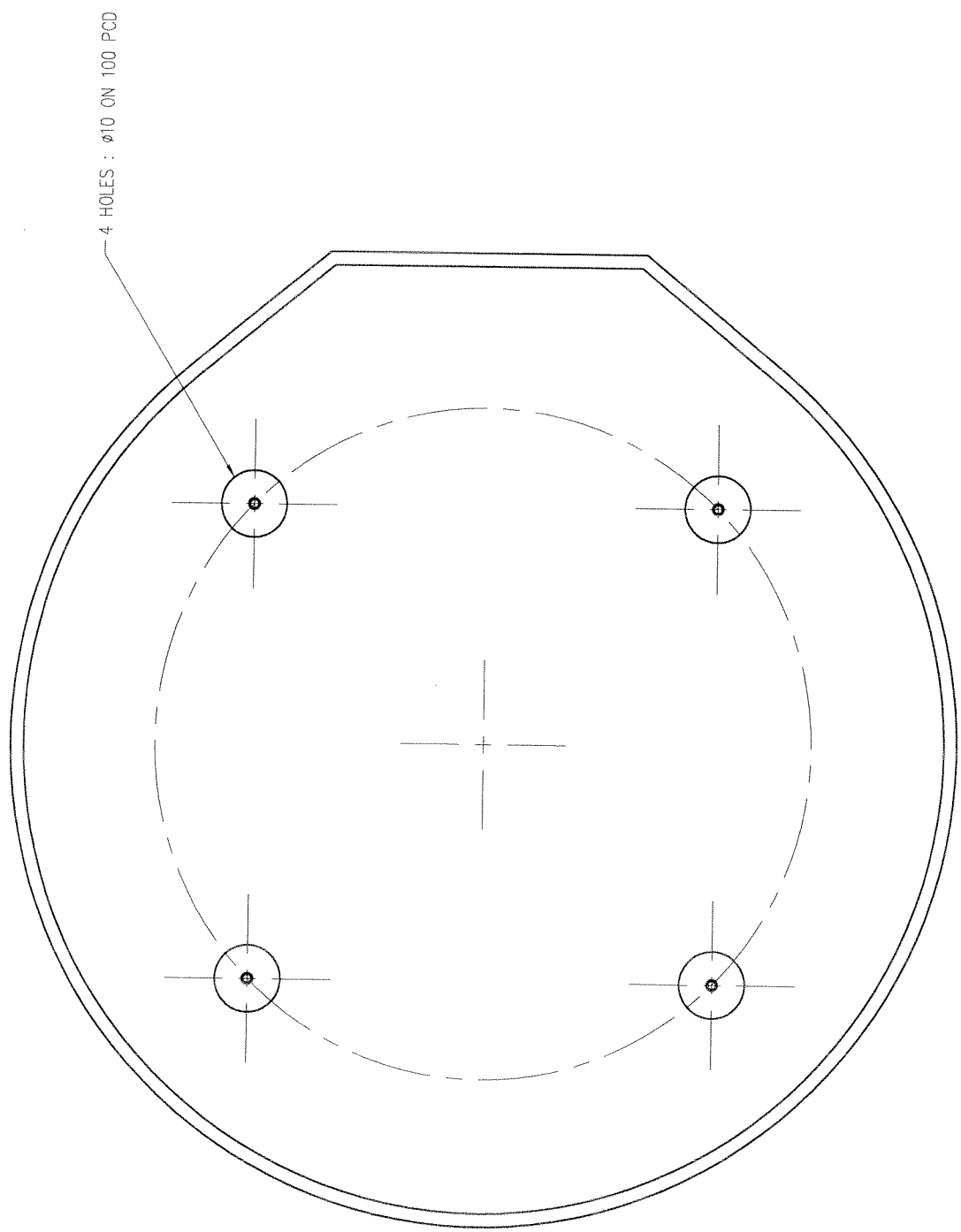

PHOTOCOPIY THIS PAGE FOR TEMPLATE

		ENGINEERING HOBART	
TITLE VM500 / VMC500 DECK TEMPLATE		PART No.	
DRN PA	DATE 26/03/93	DRG No. 1060/MD/01	SIZE A4
SCALE 1:1	APP1	APP2	
TOLERANCES (mm) X. ± 0.5 X.X ± 0.1 X.XX ± 0.025 UNLESS OTHERWISE SPECIFIED		MATERIAL	
FINISH		© COPYRIGHT MUIR ENGINEERING PTY. LTD.	

JAS ANZ

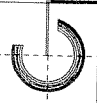

REV No. 1

DESC. REDRAW TO SCALE

BY: GJ

DATE 08/05/98

